

Measuring for your new blinds is easier than you might think! All you have to do is follow our simple tips, double-check everything you do, and set aside some time to do it. Happy measuring!

This guide works for:

- Standard & Click2Go Pleated blinds
- Cordless Pleated blinds
- Top Down/Bottom Up blinds
- Night & Day Pleated blinds
- Double Pleated blinds

Standard Windows

Recess Fitting



Exact Fitting



These handy video guides will walk you through measuring for **recess fitting** (fitting the blind inside the window recess) and **exact fitting** (fitting the blind onto the wall above the recess).

For a step-by-step written guide and for advice if your windows are a little more unusual (e.g. bay windows, or recesses that are partly tiled), keep scrolling down.

Recess fitting

Measure the full width and height of the recess [the size of the hole if you like] and we will make the appropriate deductions to ensure a perfect fit.

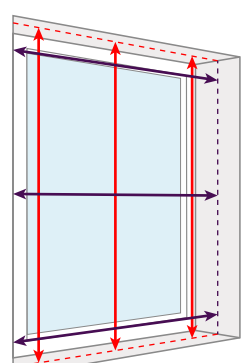

- **Measure in 3 places** for both the width and the drop, **use the smallest measurement**
- **Don't make any deductions**, we'll deduct 10mm from the width to ensure your blind fits perfectly
- **Use a metal tape measure**, cloth ones can stretch and give you inaccurate measurements

Top-Tip:

In the case of Click2Go Pleated Blinds, if there is a significant difference between the width at the top of the recess and the width at the narrowest point, we would recommend switching to a standard installation rather than Click2Go.

Top-Tip:

Check that your recess is deep enough to fit the blind into, also bearing in mind any obstructions such as handles.

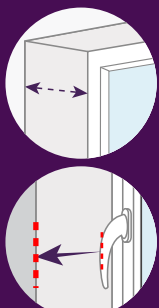

Standard / Click2Go Pleated Blind Depth
30mm

Cordless Pleated Blind Depth
50mm

Top Down/Bottom Up / Night & Day Blind Depth
30mm

Double Pleated Blind Depth
45mm

Exact fitting

Measure the full width and height of the recess [the size of the hole if you like] and add a little extra to the top and to each side, we will make the blind to the size you specify with no deductions.

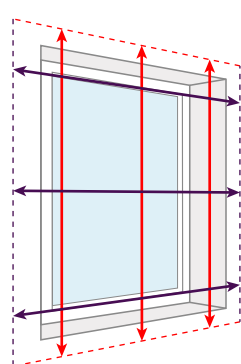

- To minimize light leakage **we recommend that the blind overlaps the window recess by at least 70mm at the top and 50mm each side**
- The overlap at the bottom of the blind is a matter of personal choice but please **take into account obstacles** such as radiators

Top-Tip:

If you are **replacing an existing blind** with one of the same size, simply measure the blind (including its fittings) and specify exact fitting, we will make you one the same size.



Other Windows

Part-tiled recesses

If you have tiles part-way up your recess (often the case in kitchens and bathrooms) then the space between them is most likely to be the narrowest point in the recess.

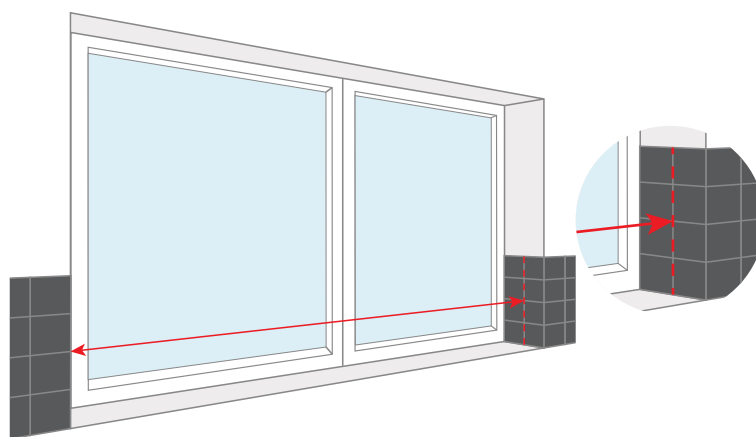

Measure between the tiles to ensure your blind will fit. **A recess of this type is not suitable for Click2Go Pleated Blinds.**

Top-Tip:

Do the same if you have a picture rail, skirting board or other items on the inside of the recess.

Bay windows, half-bays & L-shaped windows

We have some handy guides already put together especially for pleated blinds in bay windows, click on the links below to take a look!

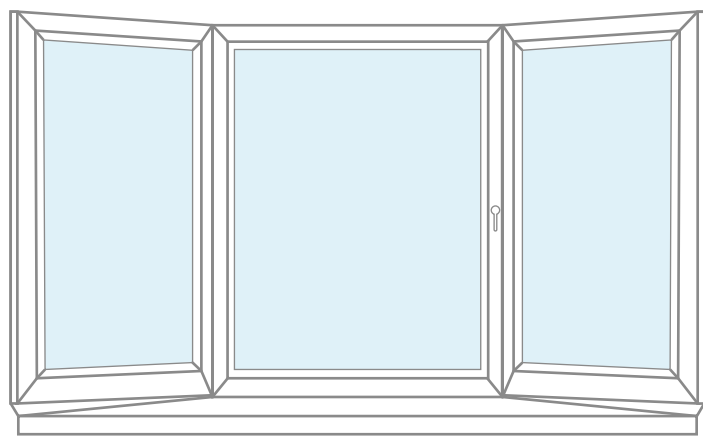

Angled bay windows
[Click here](#) for our handy guide

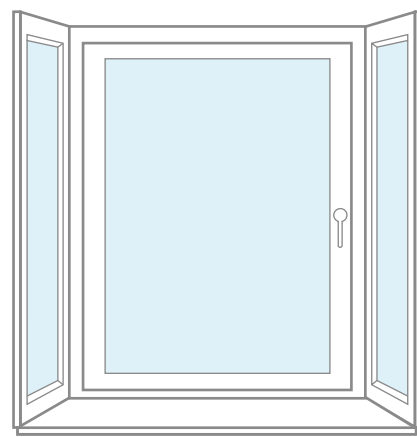

Square bay windows
[Click here](#) for our handy guide

You can use this same guide for angled half-bay windows, it's the same principle

You can use this same guide for L-shaped windows

Top-Tip:

Because Click2Go Pleated Blinds are recess fitting-only, they cannot be used in bay windows.