

Installing the brackets

1

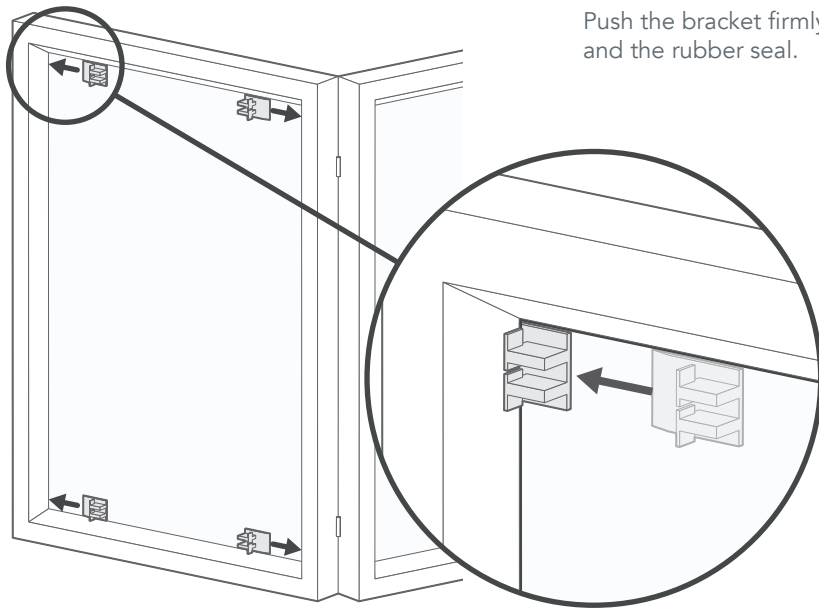

Push the bracket firmly into place between the glass and the rubber seal.

Place the brackets flat to the glass and push them in towards the frame, ensuring that they slide in under the rubber/mastik seal. Push in each bracket as far as possible, with one bracket in each corner of the glass.

Installing the blind

2

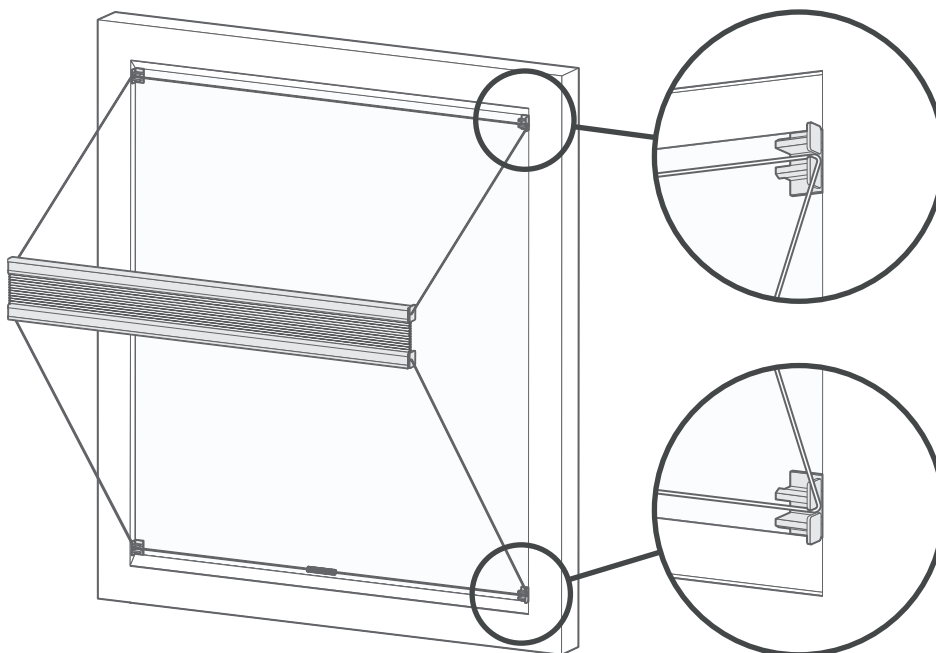

Identify which is the top of the blind and which is the bottom - the cord at the bottom of the blind has a spring joining its two ends in the centre, the top does not.

Hook the cord at the top of the blind through the centre of each of the top brackets. The cord should pass up the side of the window, through the centre of a bracket, then straight across the top of the window to the other bracket.

Do the same for the cord at the bottom of the blind, passing the cord through the centre of the brackets so that it's level across the bottom of the window.

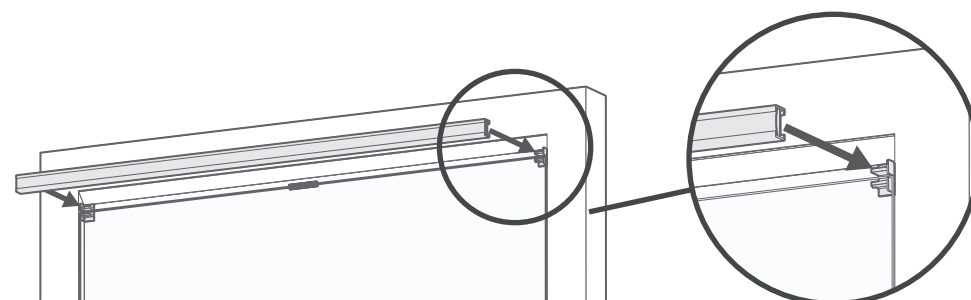

Click the two separate rails onto the brackets at the top and bottom of the window. Simply line up each rail's open side with the brackets and push firmly until it clicks into place.

Adjusting the tension

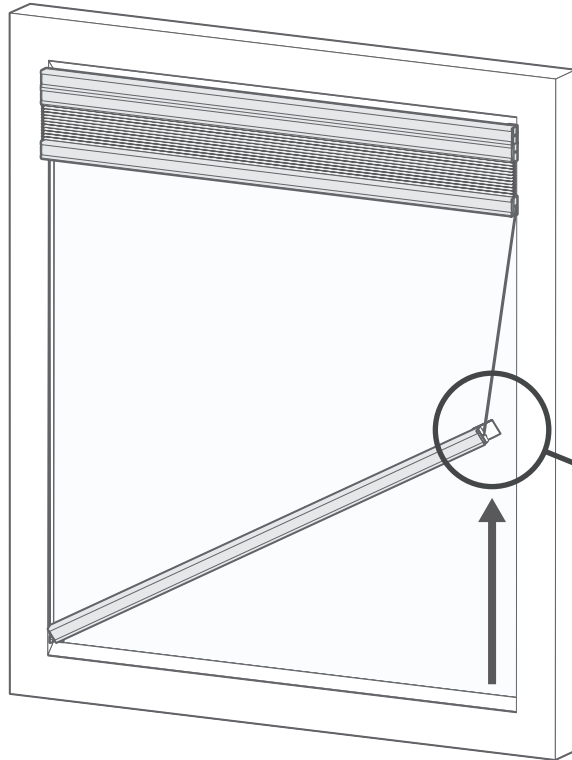

Over time the cords may slacken off and require re-tensioning. You'll know if the blind needs re-tensioning as it will begin to slip back down of its own accord when raised.

Start by removing the bottom rail - to do this, slide it upwards from one corner, to slide the bracket out from under the seal.

Then, remove the brackets from both ends of the rail and put the rail to one side.

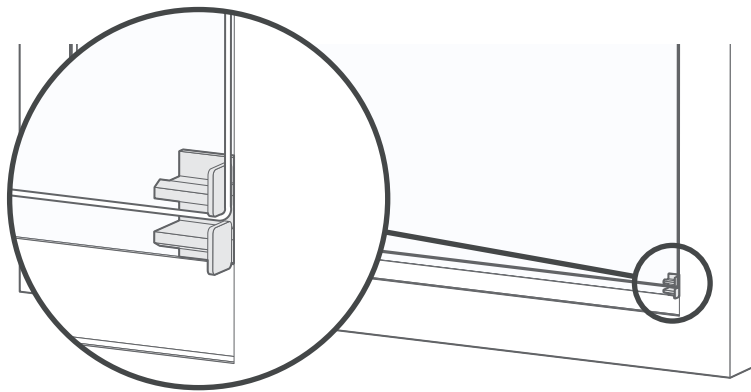
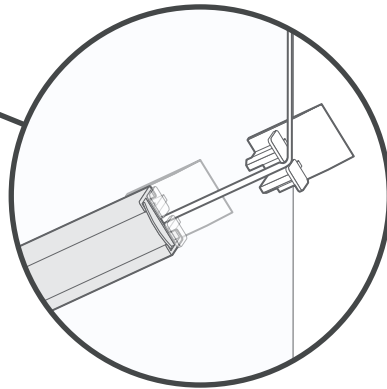

Slot the brackets back into the corners, as per step 1 of this guide.

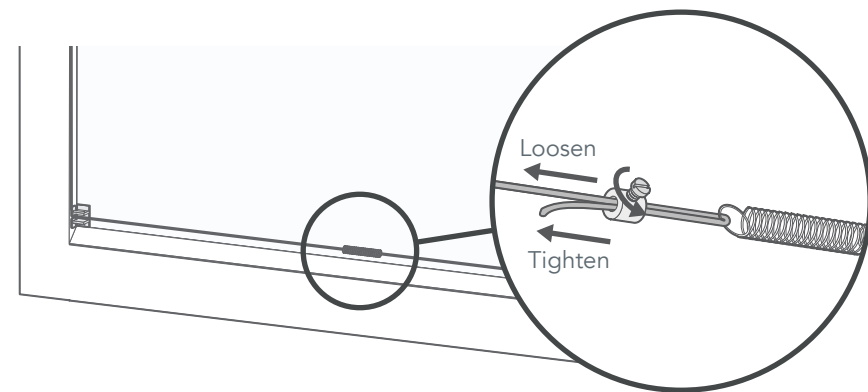

At the bottom of the blind the cord is connected to both ends of a small spring. On one side, the cord is secured by a metal sleeve with a screw.

Loosen the screw, then pull the end of the cord through by 5-10mm. Tighten the screw and give the blind a test to see if the tension is right. Repeat this as necessary, using small adjustments only, until the tension is correct.

Once you're done, simply click the bottom rail back into place.

IMPORTANT: To avoid damaging the cord, make sure that you do not over-tighten the screw.