

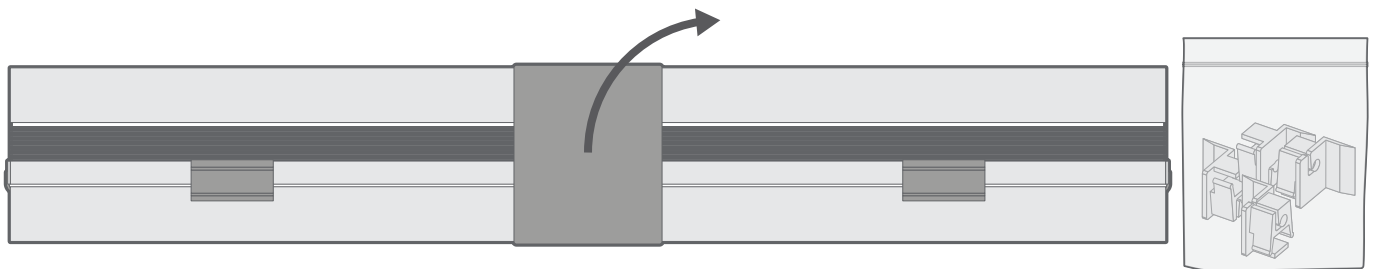

We've made a handy video version of this fitting guide, just click the play button to view it.

If you prefer to print the instructions or simply to follow step-by-step, just keep reading.

Unpacking the blind



When you remove the blind from its box you'll find the blind itself, bubble-wrapped for transit, and a separate bag containing the brackets. Remove the blind from the bubble-wrap.

You'll find that there's a slim fabric wrap around the blind to hold the parts together in transit. There are actually 3 of these, which can be removed in stages. Start by removing the first wrap (wrap number 1), leave the other fabric wraps in place for now.

Top Tip

You'll find two packs of brackets with your blind, one set of 'Thin' brackets and one set of 'Thick' brackets. The 'Thin' brackets are the standard design, so use those when you first install. If you find after installing that the brackets are a little loose beneath the rubber seal, swap out for the 'Thick' brackets.

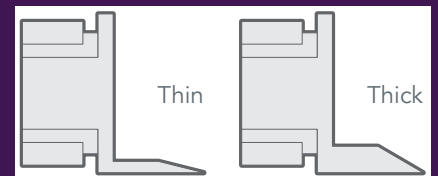

Installing the blind

- 1** Start by fitting the top two brackets. Hold each bracket against the glass and push the slim 'wedge' shaped part under the rubber seal in the top corner of the glass.

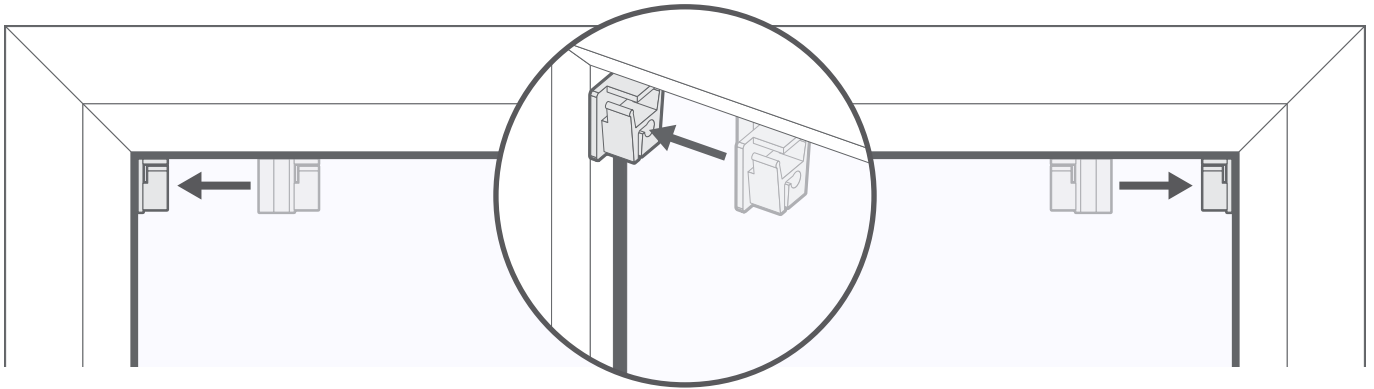

Note that the brackets have a specific alignment. Look at the back of the brackets to easily identify where they will be fitted.

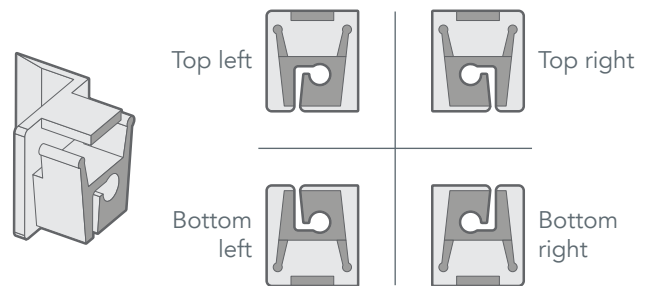

- 2** Take the blind and push the top of the headrail up into the brackets until it clicks into place on both sides.

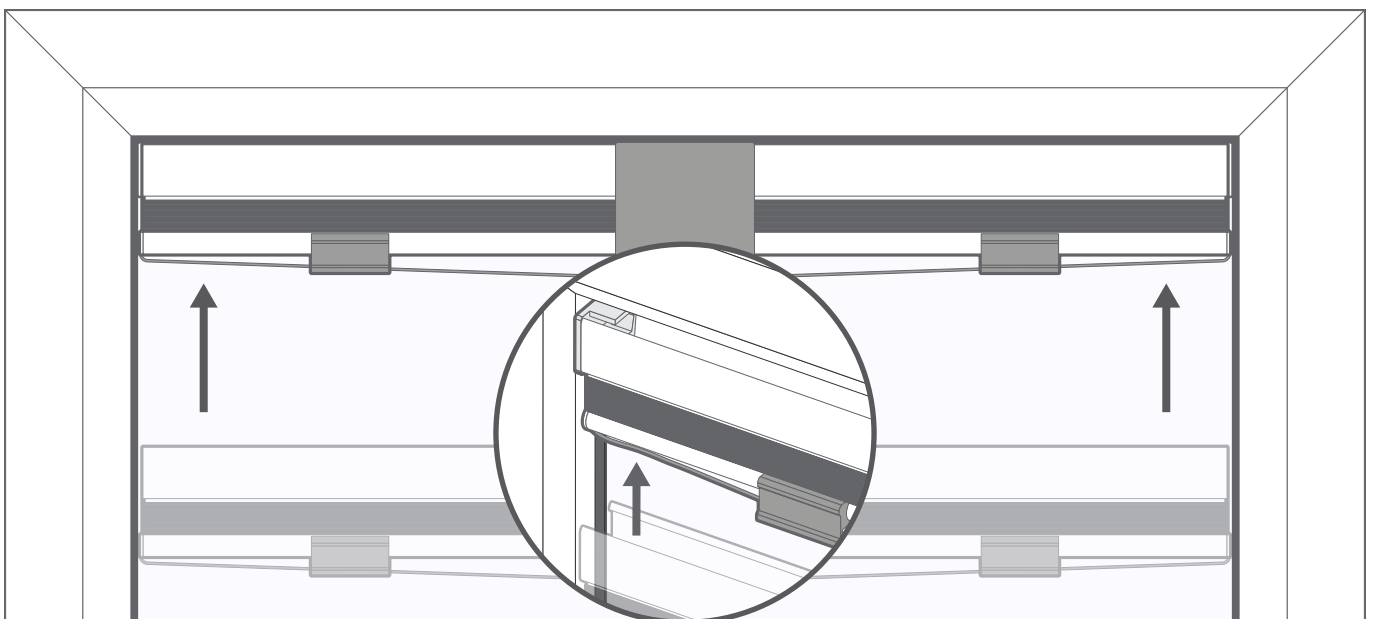

3

Slide the bottom brackets into place in the bottom corners of the glass, just as you did with the top brackets in step 1.

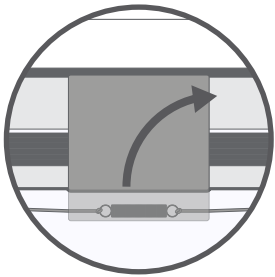
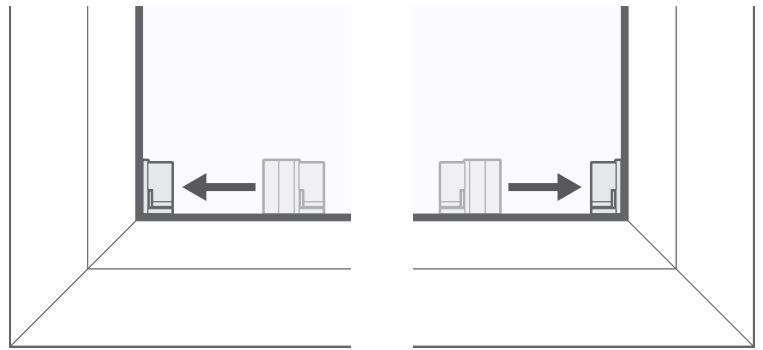

Remove wrap number 2 to release the cord.

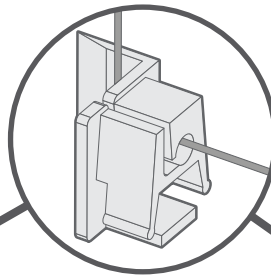

Pull the cord to the bottom of the glass and hook it into the bottom brackets. Try to make sure that the spring connecting the two ends of the cord is in the centre.

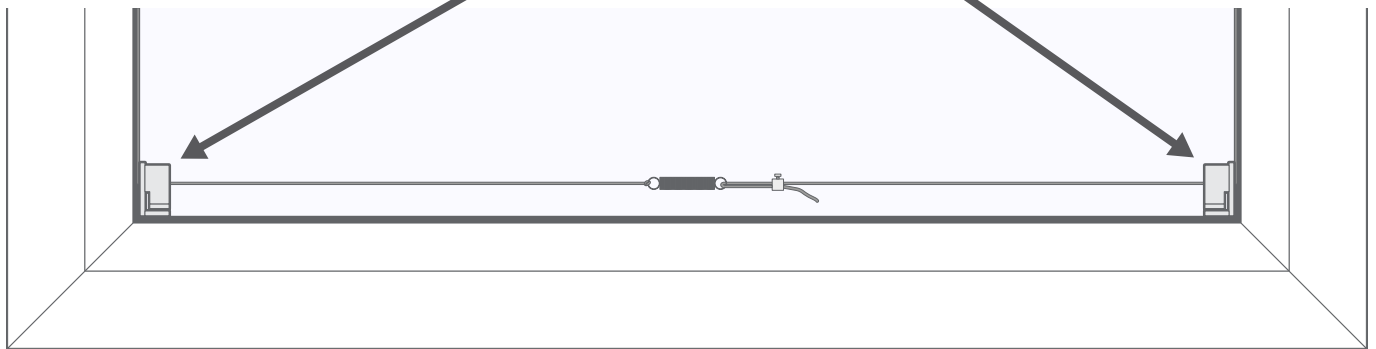

4

Click the loose bottom bar onto the bottom brackets, in the same way as you clicked the blind into place in step 2.

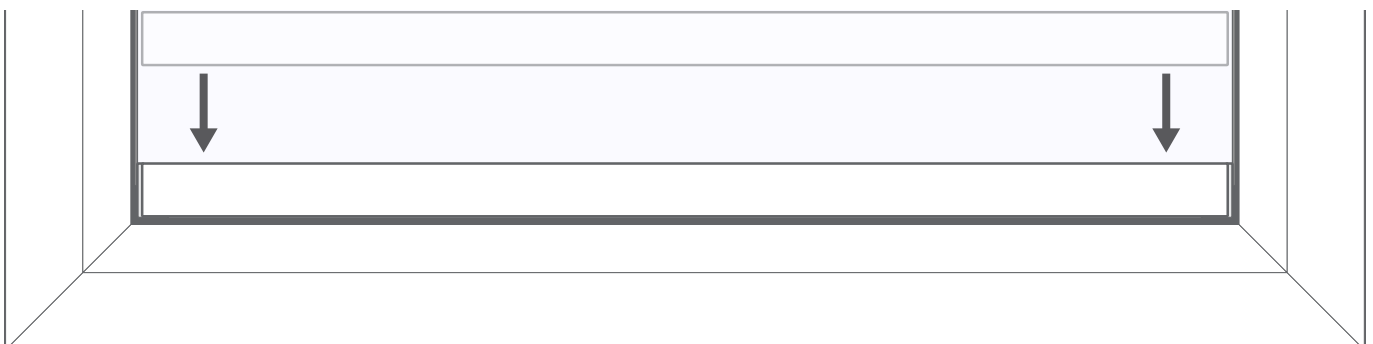
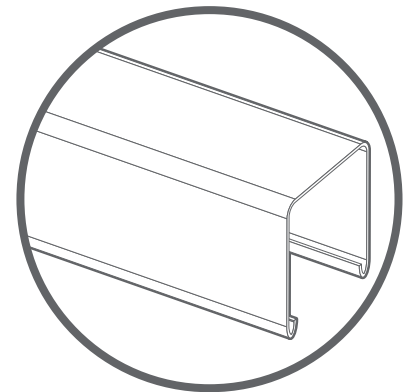

- ⑤ Finally, remove wrap number 3 from the blind.

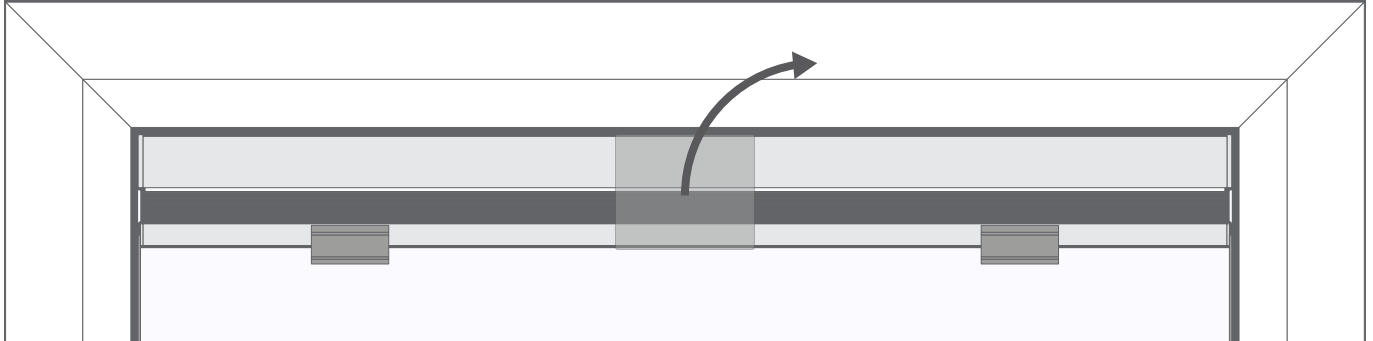

And that's it, your new blind is installed and ready to enjoy!

Adjusting the tension

Over time the cords may slacken off and require re-tensioning. You'll know if the blind needs re-tensioning as it will begin to slip back down of its own accord when raised.

Start by removing the bottom rail - to do this, slide it upwards from one corner, to slide the bracket out from under the seal.

Then, remove the brackets from both ends of the rail and put the rail to one side.

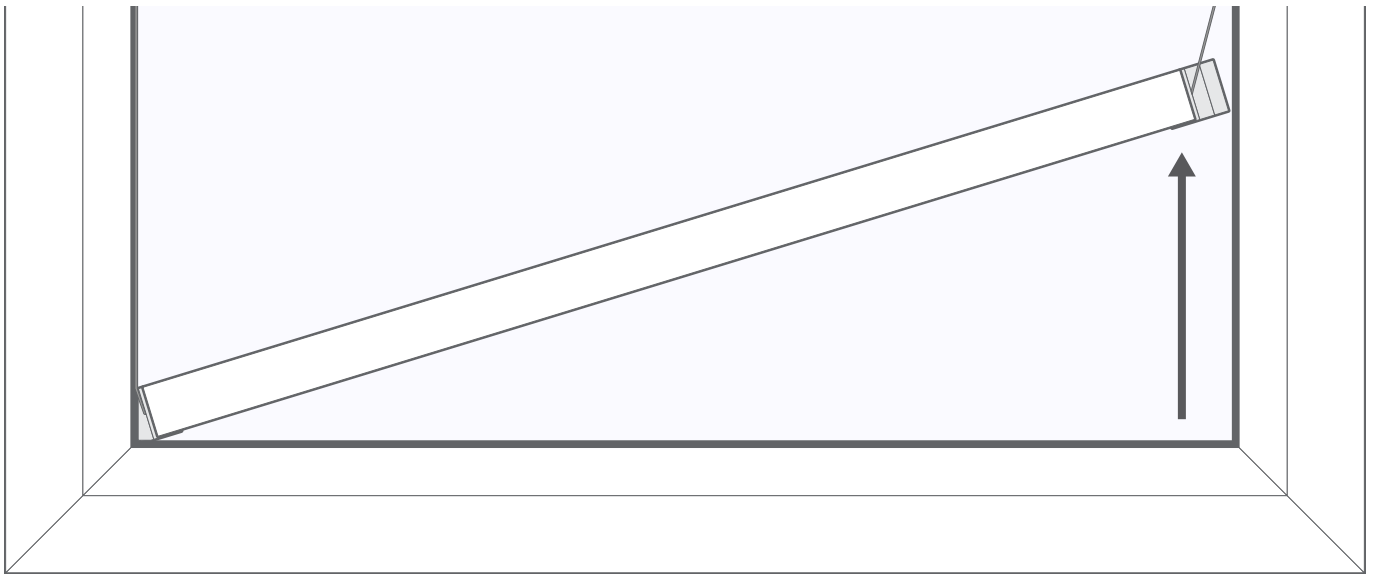

Hook the cord back into the brackets and slot the brackets back into place.

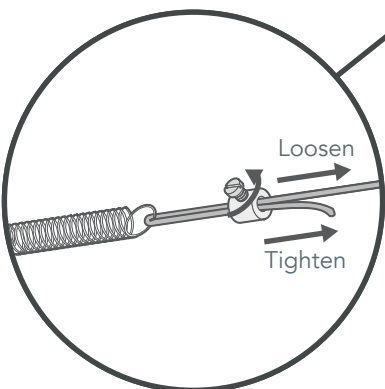
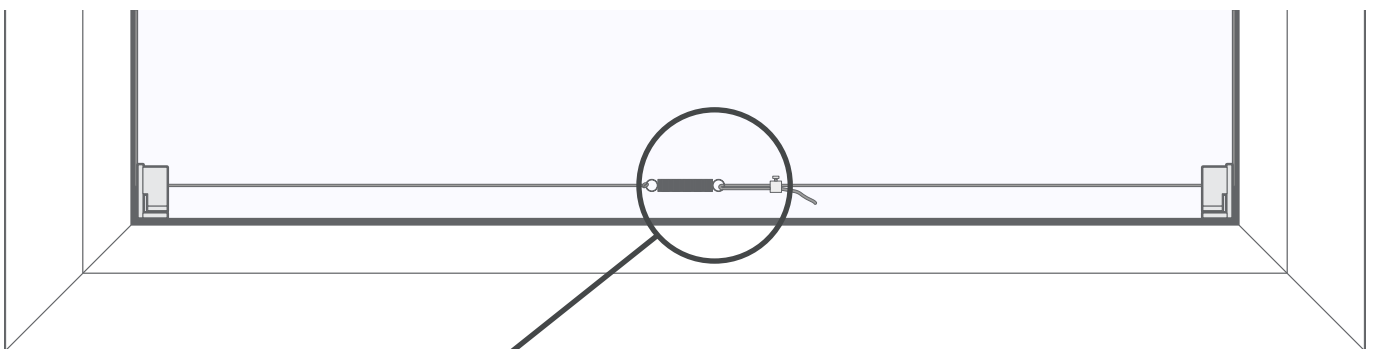

At the bottom of the blind the cord is connected to both ends of a small spring. On one side, the cord is secured by a metal sleeve with a screw.

Loosen the screw, then pull the end of the cord through by 5-10mm. Tighten the screw and give the blind a test to see if the tension is right. Repeat this as necessary, using small adjustments only, until the tension is correct.

Once you're done, simply click the bottom rail back into place.

IMPORTANT: To avoid damaging the cord, make sure that you do not over-tighten the screw.