

Measuring for your new blinds is easier than you might think! All you have to do is follow our simple tips, double-check everything you do, and set aside some time to do it. Happy measuring!

This guide works for:

- TotalShade Blackout Thermal Blinds
- MaxShade Blackout Thermal Blinds
- Click2Shade Blackout Thermal Blinds

Standard Windows

Recess fitting

Measure the full width and height of the recess [the size of the hole if you like] and we will make the appropriate deductions to ensure a perfect fit.

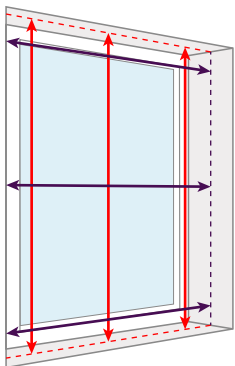

- **Measure in 3 places** for both the width and the drop, **use the smallest measurement**
- **Don't make any deductions**, we'll deduct a small amount from the width and drop to ensure your blind fits perfectly. For TotalShade & MaxShade Blinds we'll deduct a total of 4mm, and for Click2Shade Blinds we'll deduct just 1mm.
- **Use a metal tape measure**, cloth ones can stretch and give you inaccurate measurements

Top-Tip:

Check that your recess is deep enough to fit the blind into, also bearing in mind any obstructions such as handles. It's important that you also leave at least 50mm between the back of the fabric and the window, so this is included in the depth required.

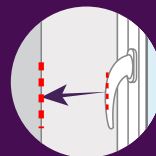

Blind Depth + 50mm

TotalShade **75mm**

MaxShade **80mm**

Click2Shade **110mm**

Exact fitting (not applicable for Click2Shade Blinds)

Measure the full width and height of the recess [the size of the hole if you like] and add a little extra to the top and to each side, we will make the blind to the size you specify with no deductions.

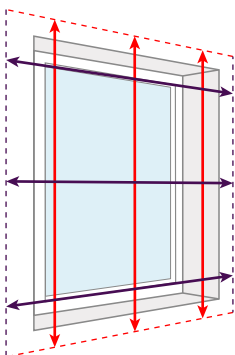

- To minimize light leakage **we recommend that the blind overlaps the window recess by at least 70mm at the top and 50mm each side**
- The overlap at the bottom of the blind is a matter of personal choice but please **take into account obstacles** such as radiators

Top-Tip:

If you are **replacing an existing blind** with one of the same size, simply measure the blind (including its fittings) and specify exact fitting, we will make you one the same size.

