

Measuring for your new Panel Blinds is easier than you might think! All you have to do is follow our simple tips, double-check everything you do, and set aside some time to do it. Happy measuring!

## Standard Windows

Recess Fitting



Exact Fitting



These handy video guides will walk you through measuring for **recess fitting** (fitting inside the window recess) and **exact fitting** (fitting onto the wall above the recess). **We would always recommend exact fitting for our Panel Blinds.**

### Exact fitting (recommended)

Measure the full width and height of the recess [the size of the hole if you like] and add a little extra to the top and to each side, we'll make the Panel Blinds to the size you specify with no deductions.

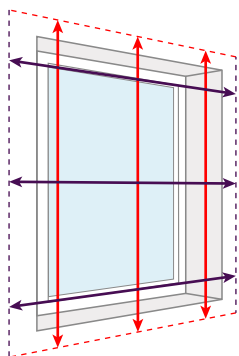

- To minimize light leakage **we recommend that the Panel Blinds overlap the window recess by at least 70mm at the top and 50mm each side**
- The overlap at the bottom is a matter of personal choice but please **take into account obstacles** such as radiators

#### Top-Tip:

If you are **replacing an existing blind** with one of the same size, simply measure the blind (including its fittings) and specify exact fitting, we will make you one the same size.

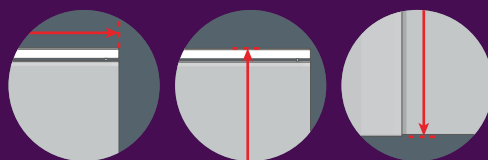

### Recess fitting

Measure the full width and height of the recess [the size of the hole if you like] and we will make the appropriate deductions to ensure a perfect fit.

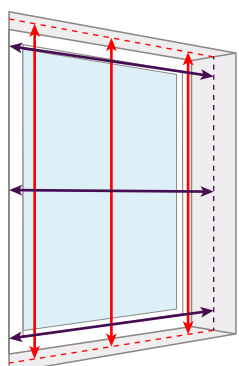

- **Measure in 3 places** for both the width and the drop, **use the smallest measurement**
- **Don't make any deductions**, we'll deduct 10mm from the width and 15mm from the drop to ensure your Panel Blinds fit perfectly
- **Use a metal tape measure**, cloth ones can stretch and give you inaccurate measurements

#### Top-Tip:

Check that your recess is deep enough to fit the Panel Blinds into, also bearing in mind any obstructions such as handles.

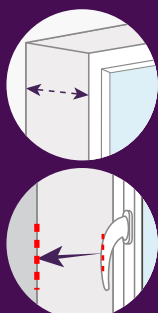

Panel Blind Depth	
Width of recess is 141cm or less	Width of recess is more than 141cm
55mm	90mm