



Not recommended



Minimum



Recommended

Please note that we **STRONGLY** recommend using at least 2 people, preferably 3, for this installation. Our awnings are designed for DIY installation but are very heavy, and attempting to install alone can be difficult and even dangerous.

You will need...

- 1x Hammer drill
- 1x 16mm masonry drill bit
- 1x Hammer
- Chalk or pencil
- 1x Long spirit level (or laser level)
- Spanner set & adjustable spanner
- 2x Step ladders

Included in the parcel...

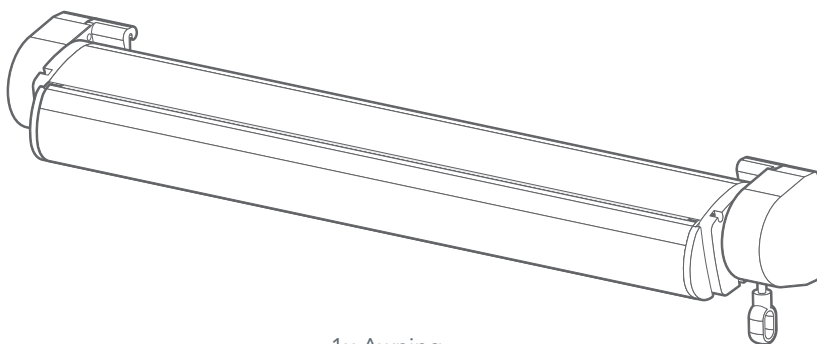

1x Awning

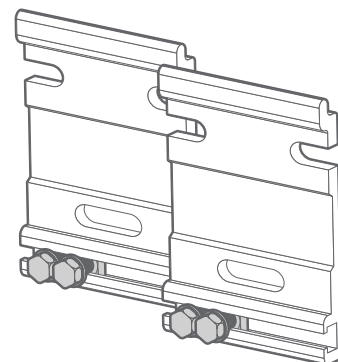

2x Mounting brackets with 4x retaining bolts

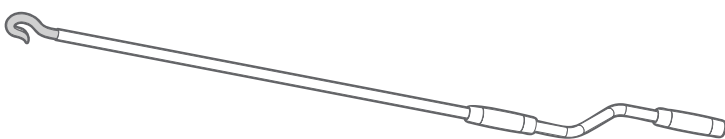

1x Crank handle

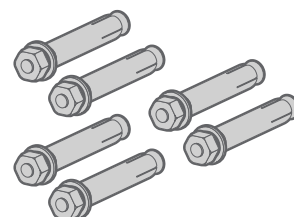

6x Wall anchors

Line up and mark out your fitting location

1

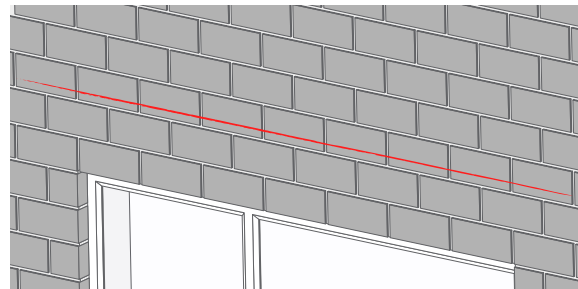
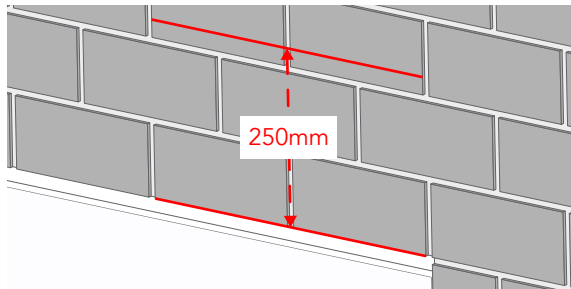

Measure 250mm up from the top of the window. This is the minimum height at which the awning should be installed above the window. Using a spirit level and chalk, mark a straight line all the way across the fitting area at this 250mm height.

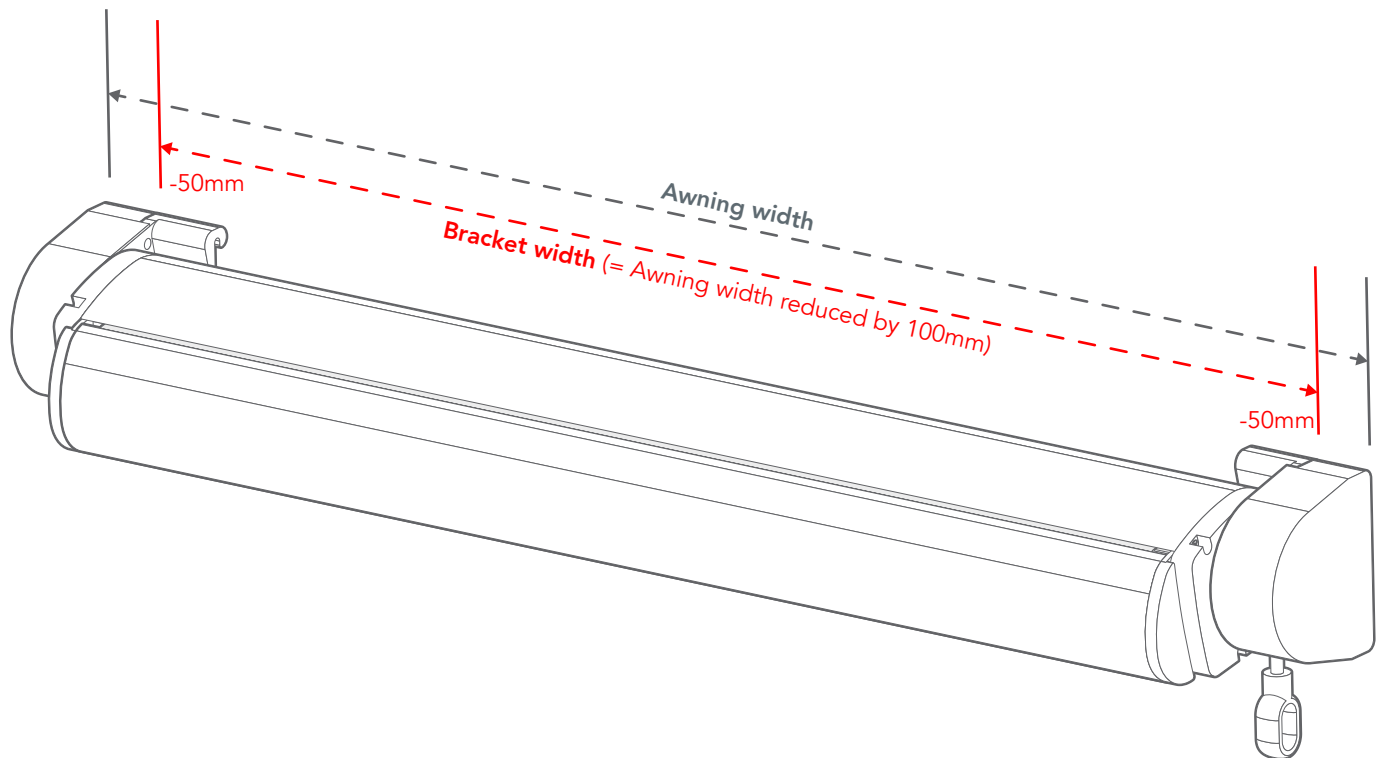

Take the full width of the awning and deduct 50mm from each end. This new width will be the width between the outer sides of the mounting brackets. We'll call this the 'bracket width'.

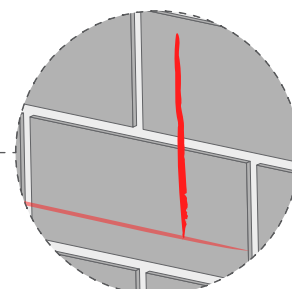
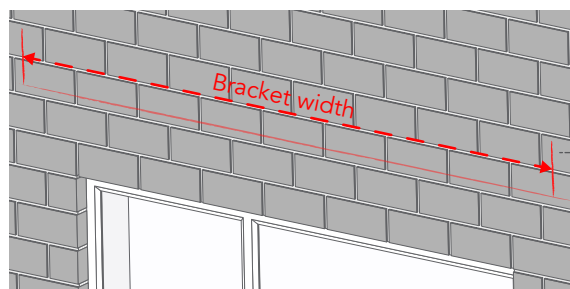

Draw two vertical lines, going up from your 250mm mark. The distance between these vertical marks should be your bracket width.

Install the brackets

2

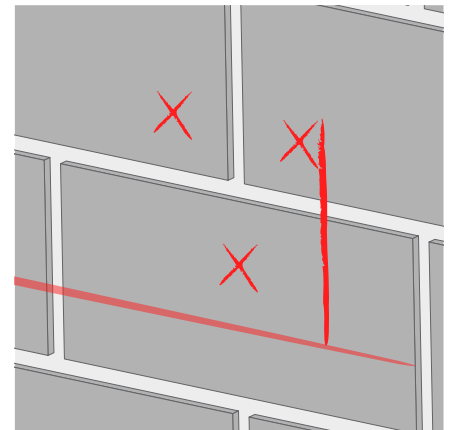
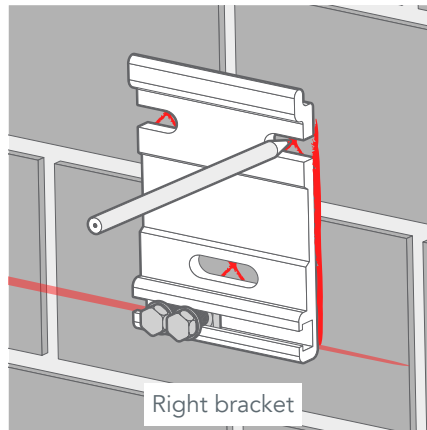
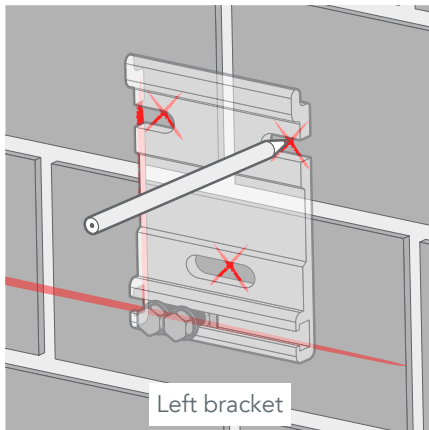

Hold each bracket up with its edge against each vertical line, so that the outer edge of the bracket is against the line. Line up the bottom of the brackets with the horizontal line. Use chalk or a pencil to mark out the locations of the screw holes on the wall - the lower screw hole should be marked on the row of bricks on or above the 250mm line above the window. Try to line up the bracket so that the screw holes are ALL as far from the mortar between bricks as possible; you might have to adjust the position of the brackets to achieve this, but make sure that you only move the brackets higher, not lower or to the side.

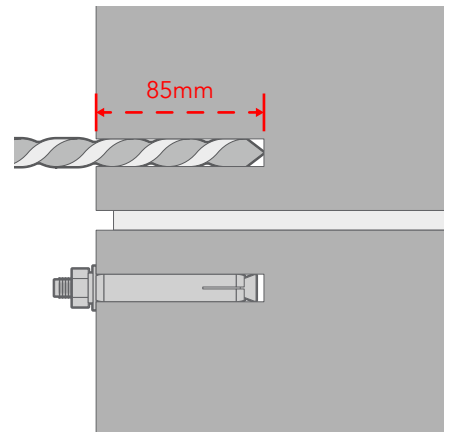
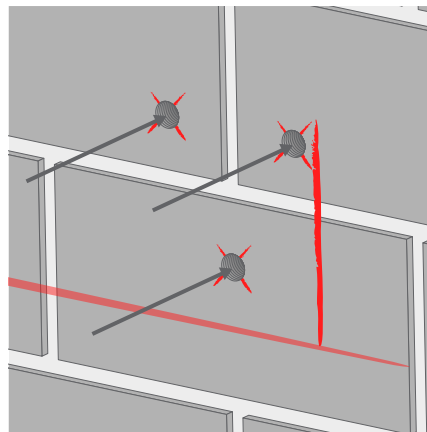
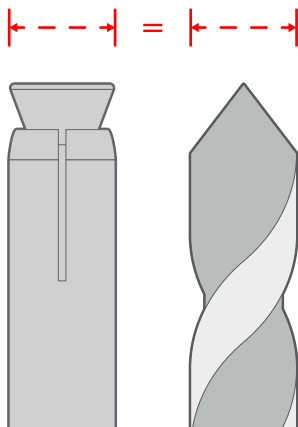

Using a drill bit that matches the diameter of the wall anchors, drill a hole at each screw-hole mark. The drill holes should be roughly 85mm deep.

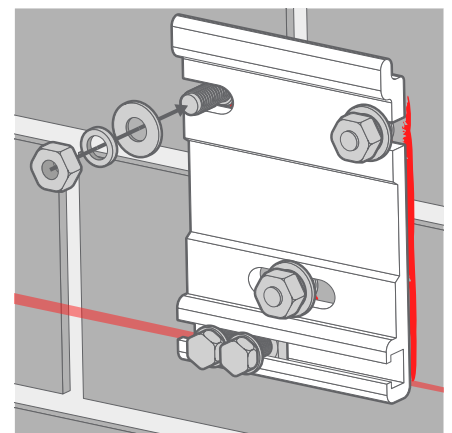
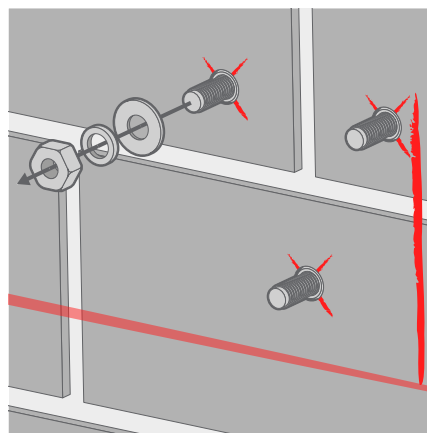
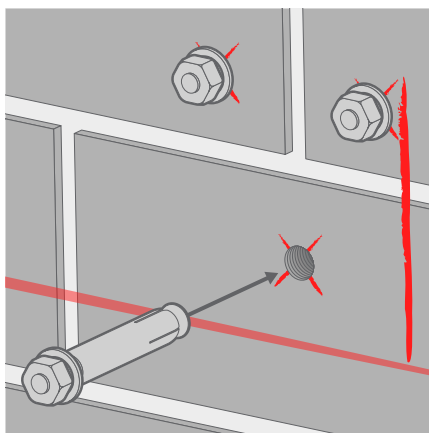

Take the wall anchors and screw on their nuts and washers with your fingers - they don't need to be tight. Hammer the anchors into your screw holes until the washers are touching the wall. Remove the nuts and washers, slot your brackets over the protruding bolts, then screw the nuts and washers back on to secure the brackets. At this stage we would recommend screwing them on loosely so that the anchors can be removed if you need to adjust their positioning later on; once fully tightened, the anchors will be tricky to remove.

Install the awning

3

IMPORTANT

Remember, our awnings are heavy, so please do not attempt the installation with only one person. A minimum of two people installing is recommended, three is ideal.



Top-Tip

Before hanging the Awning, make sure that the brackets are level. If you have a long enough object you know to be straight, you could rest this over the top of the brackets and use a spirit level. If not, simply measure from the top of the bracket down to the ground, checking that the measurements are the same.

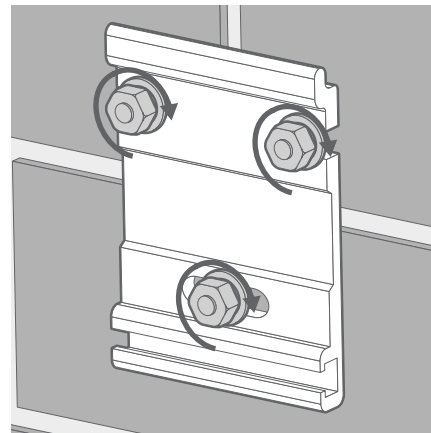
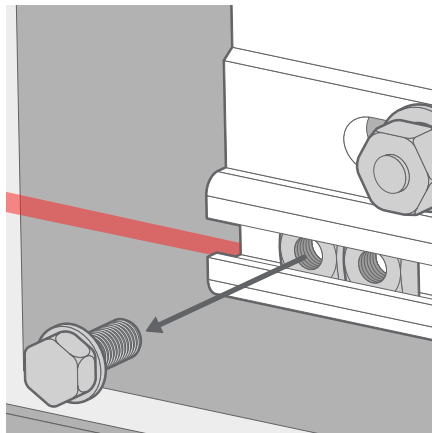
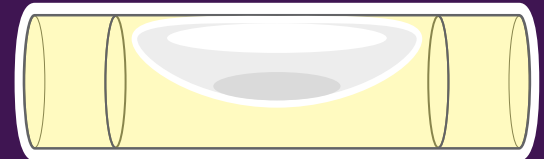

Unscrew and remove the retaining bolts from the bottom of each bracket, leaving their square nuts in place inside the brackets, and put them safely to one side - you'll need them to complete the installation. Tighten the bolts holding the brackets to the wall so that they're fully secure.

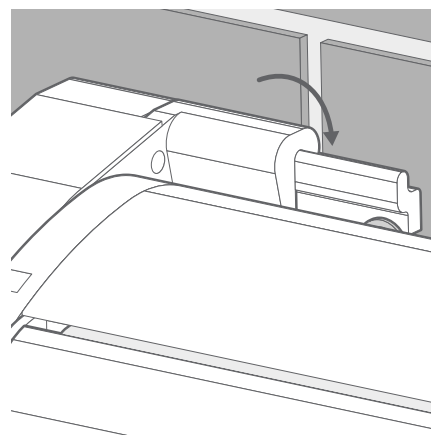
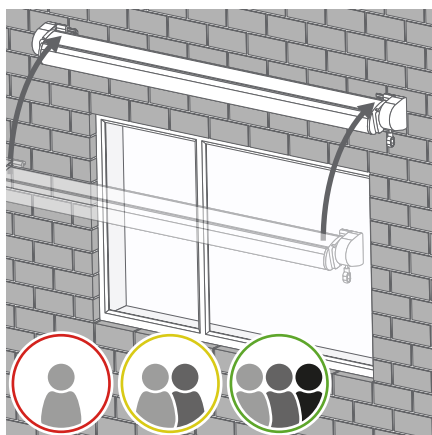

Next, lift the awning into place, hooking the back hooks at either end of the awning onto the brackets. Remember, this requires at least 2 people, one at each end, preferably with a third person supporting the centre of the awning. Check that the awning is level and hooks securely onto the brackets.

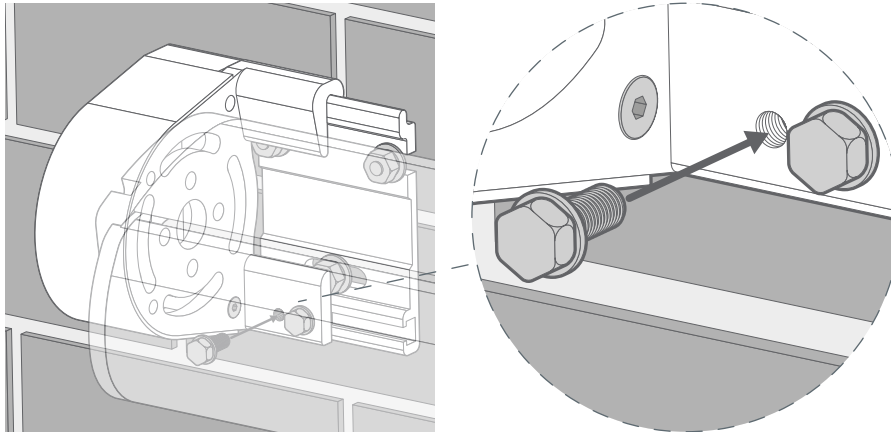

Reinsert the retaining bolts through the awning and into the brackets, so that they screw into the square nuts in the brackets.

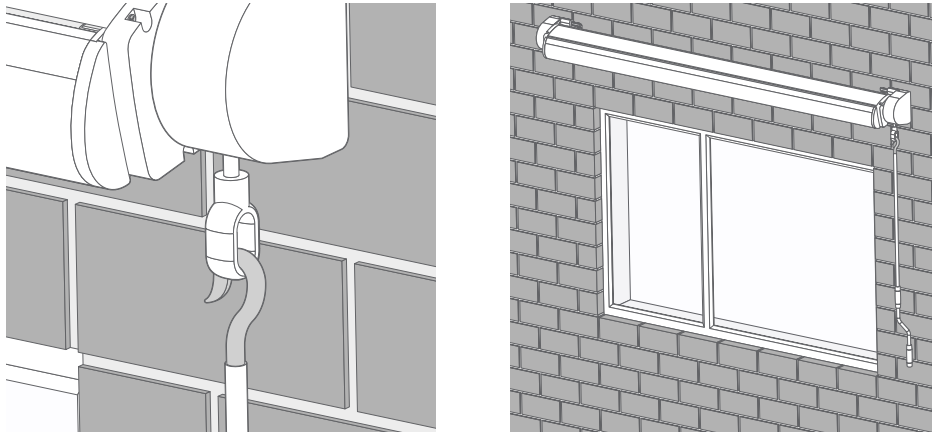

Hook the crank handle onto the awning's crank mechanism to complete the installation.

Aftercare

Maintaining your awning properly throughout the year will greatly extend its lifespan and ensure that it remains reliable and in good condition for years to come. Follow these simple routines to correctly care for your awning:

- Remove the crank handle when the awning is not in use
- The fabric is hardwearing and weather resistant, but if it gets wet then take the next opportunity to extend the awning and allow the fabric to dry
- Clean all metal parts of the awning with warm water and a soft cloth or sponge, at least once a year
- Wipe the fabric with a soft cloth or sponge, using warm water and mild detergent, at least once a year
- Spray any moving parts of the awning (the crank mechanism in particular) with silicon spray or WD-40, twice a year
- Take down and store your awning somewhere dry when it is not being used for long periods

IMPORTANT

- An awning is designed primarily for shading and sun protection. The awning should be fully retracted during periods of wind, heavy rain or snow. If it is left extended in these conditions there is a risk of damage to the awning or the structure to which it is installed.
- It's important that you always have the awning either fully retracted when not in use, or fully extended when in use, as the extending arms are strongest in these positions. When fully extended, the extending arms should be slightly bent with a visible gap between them, not locked out straight.