

No specialist knowledge or DIY experience is required to fit our blinds, but note that certain parts of this process are much easier if you have another person with you to help you install.

Fitting the Click2Go rail

1

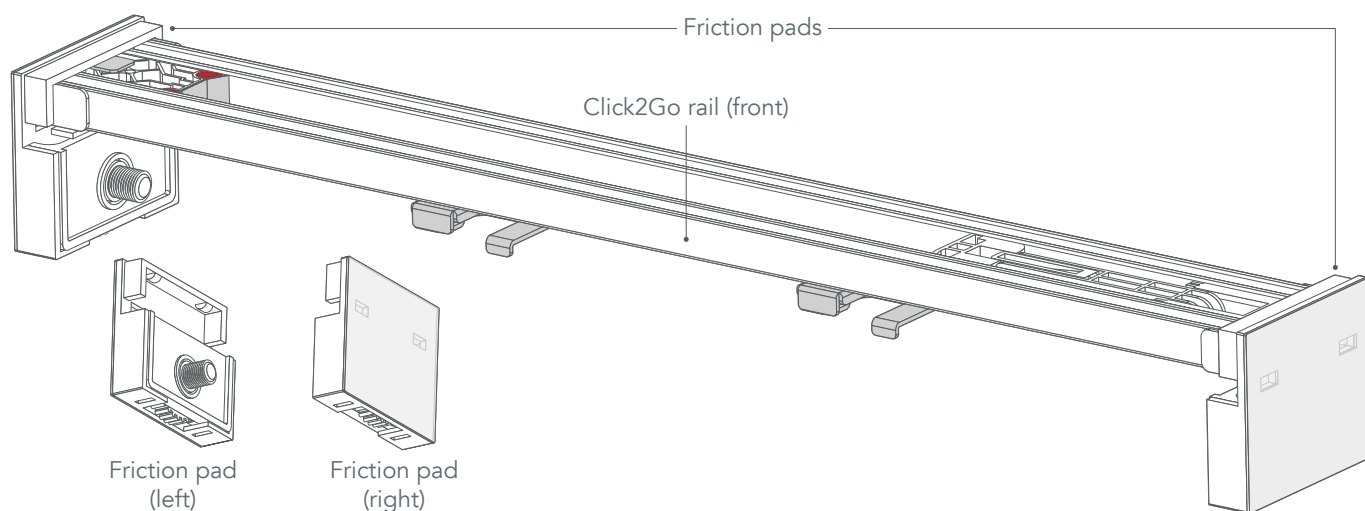

The Click2Go rail consists of the rail itself, a pair of friction pads that slot onto each end, and the pre-attached brackets you'll use to attach it to the blind. The click2Go rail should be installed in the recess first, before assembling any parts of the blind.

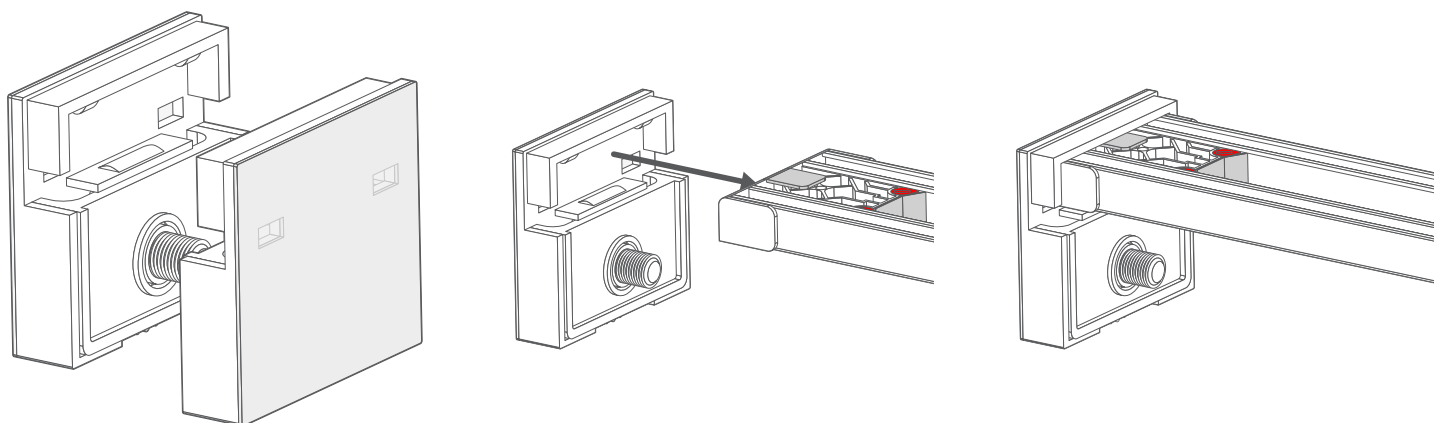

Start by taking the friction pads out of the packaging and slotting them onto the ends of the Click2Go rail. Slot one securely onto each end.

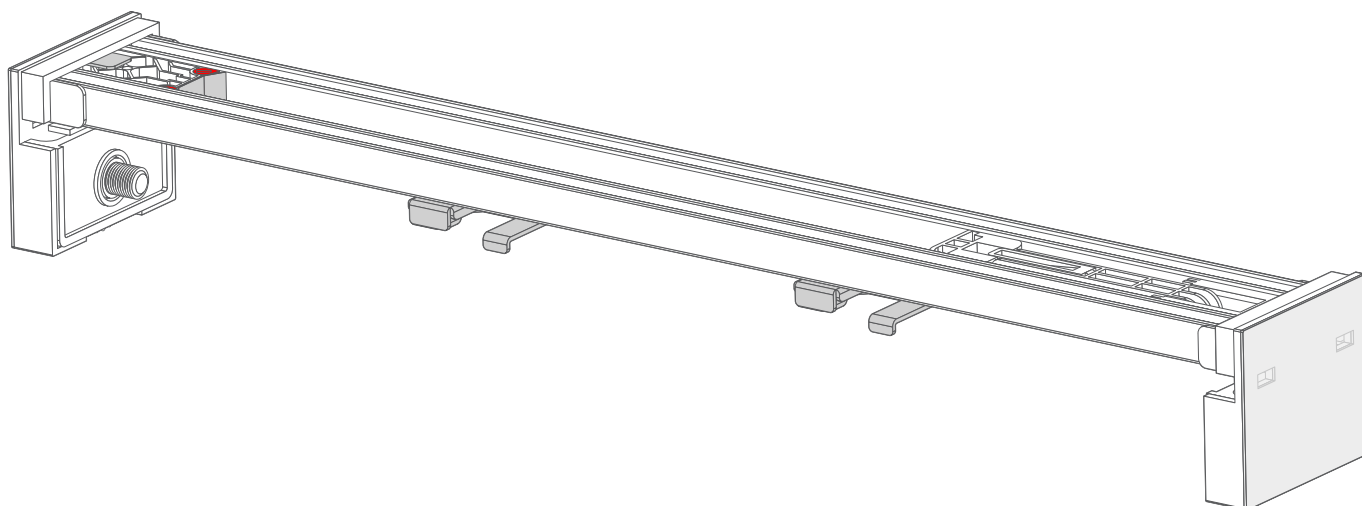

Fitting the Click2Go rail

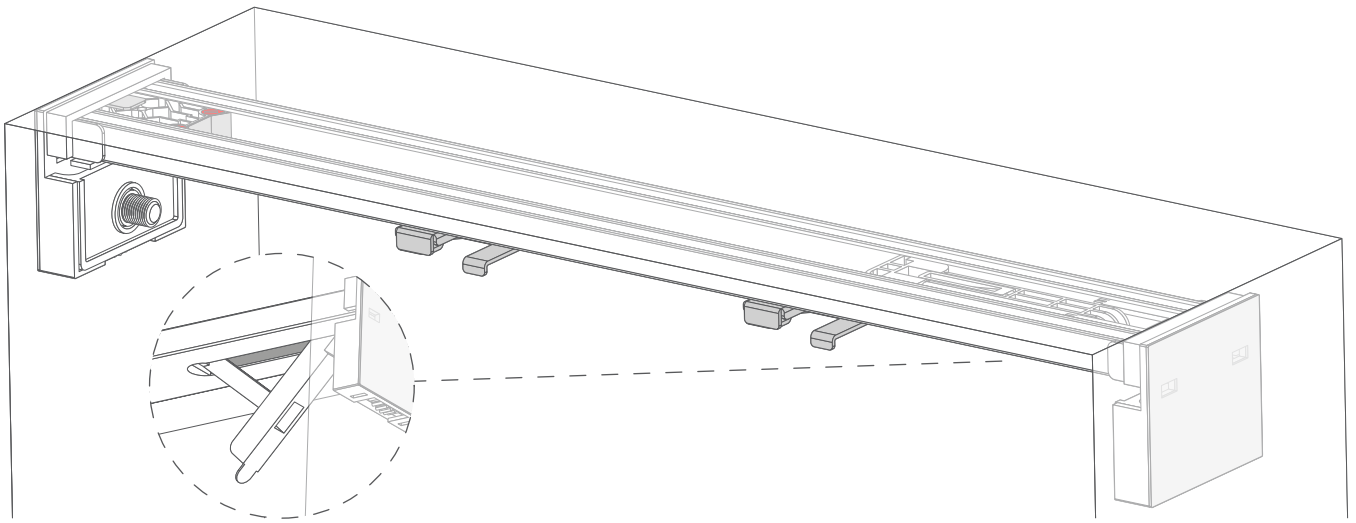

Make sure that the lever on the underside of the rail is loose and pointing down.

Raise the rail into the top of the recess, making sure that it's straight and level.

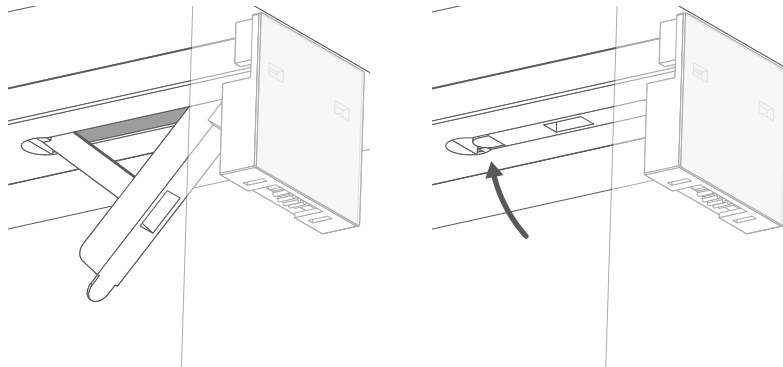

Holding the rail steady, push the lever up hard until it snaps into place, flush with the rail. This will push the tension pads out against the wall, bracing the rail securely in position.

Adjusting the rail's tightness (optional)

Top Tip

Check how tightly the rail is holding in the recess by pulling down on it with some force - if it's holding tight, you can skip to the next page.

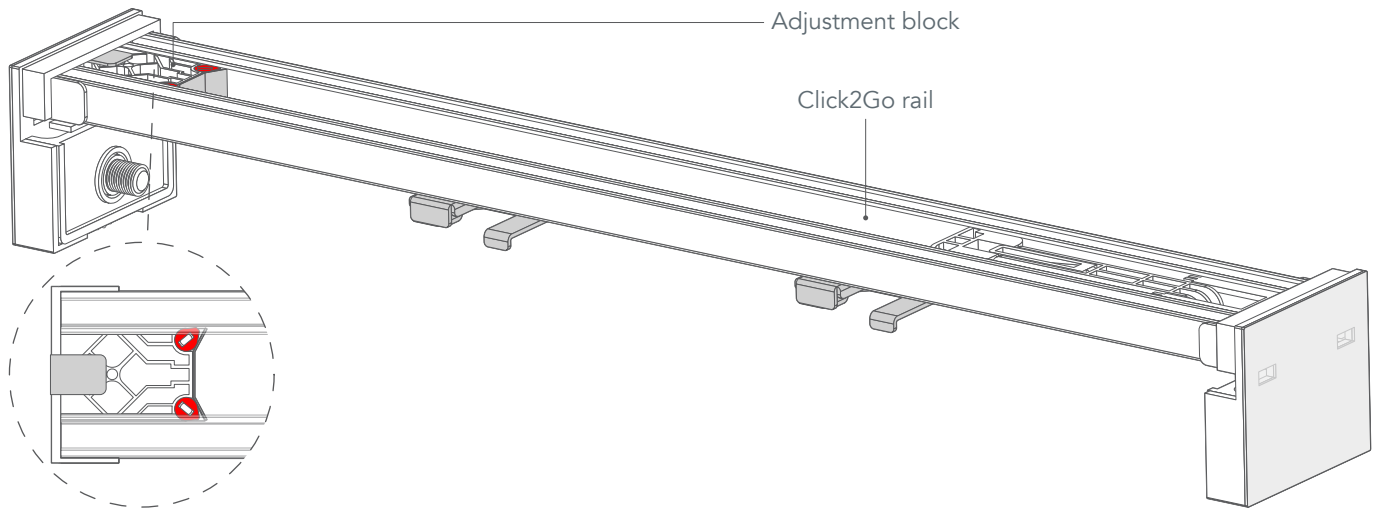

If you find that the rail is a little loose when fitted then there is an adjustment block at the end of the rail opposite to the lever. This block can be extended out slightly to widen the rail and make it a tighter fit in the recess.

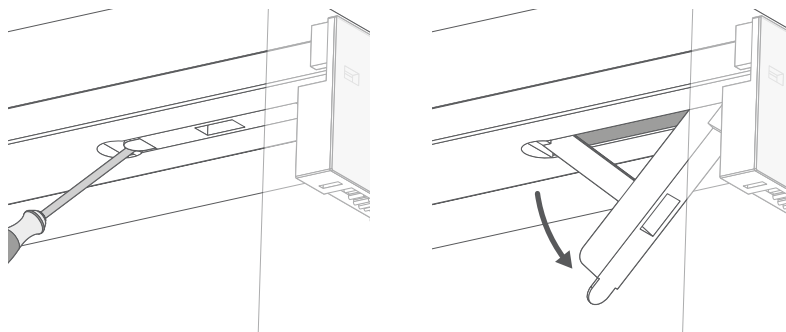

If you've already put the rail up but would like to make it tighter, then you'll need to take it back down first, but that's easy. Using a screwdriver, gently pry open the lever until it snaps back down and releases the rail. Make sure you hold the rail steady as you do this.

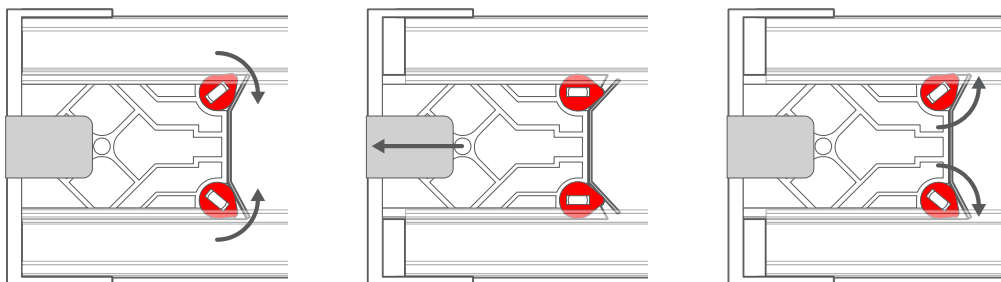

Using your screwdriver, turn the red bracers in the adjustment block toward the centre of the rail. This will allow you to pull the block out of the rail by a few millimetres. Turn the bracers back to how they were to stop the adjustment block from pushing back in. Only make a small adjustment, pulling the block out by around 5mm, and put the rail back in the recess to check its tightness before making further adjustments.

Fitting the blind

2

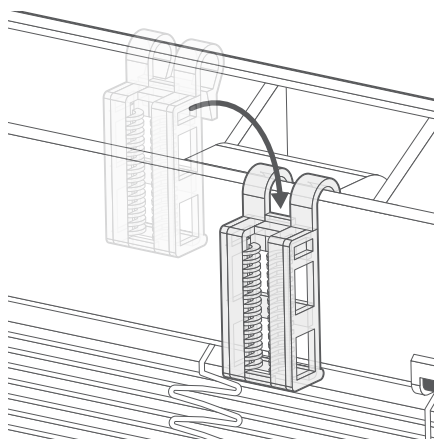
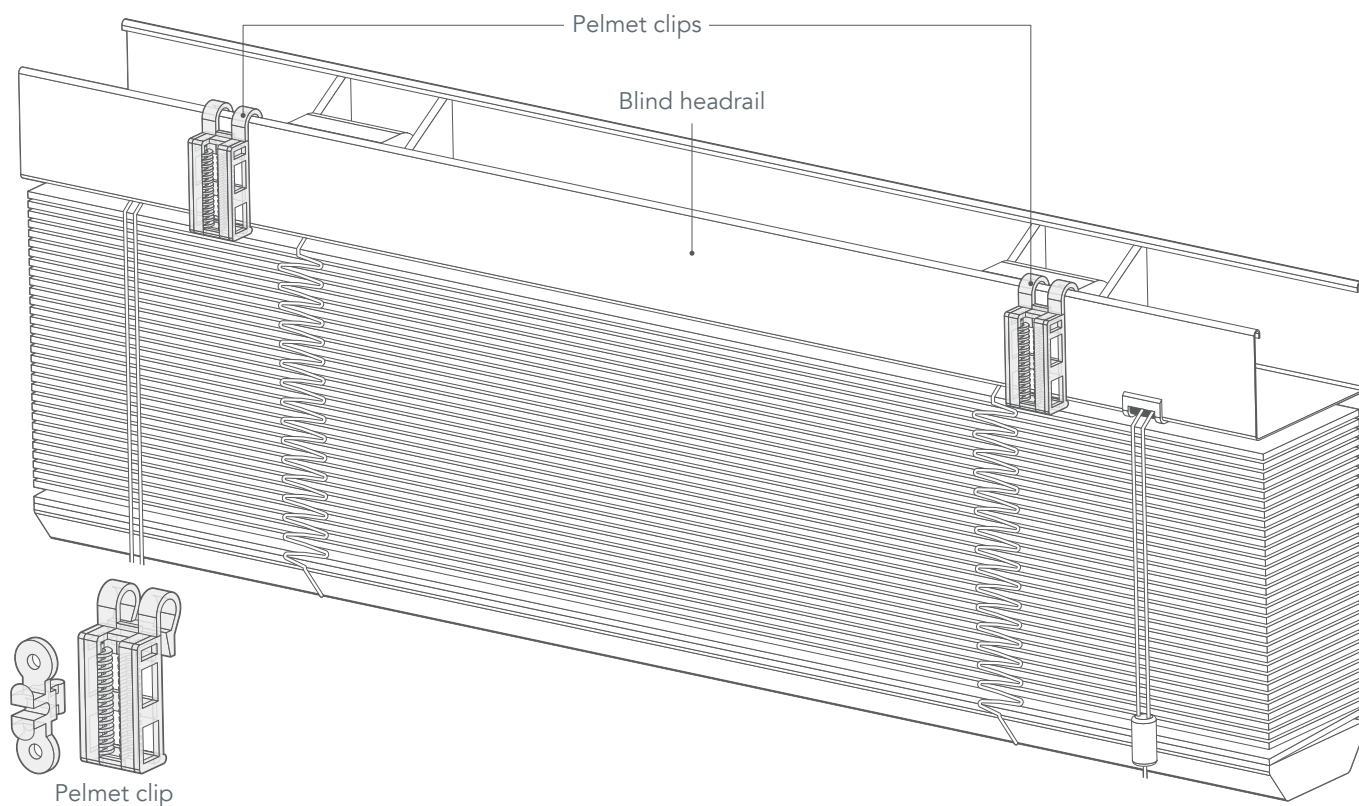

Start by hooking the pelmet clips over the front of the blind's headrail, and spacing them out evenly across its width.

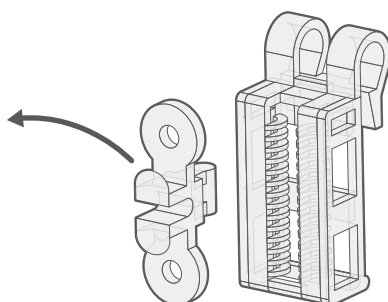

The clips are comprised of 2 parts - the smaller part with the circular eyelets can be put to one side for now. You'll need them later.

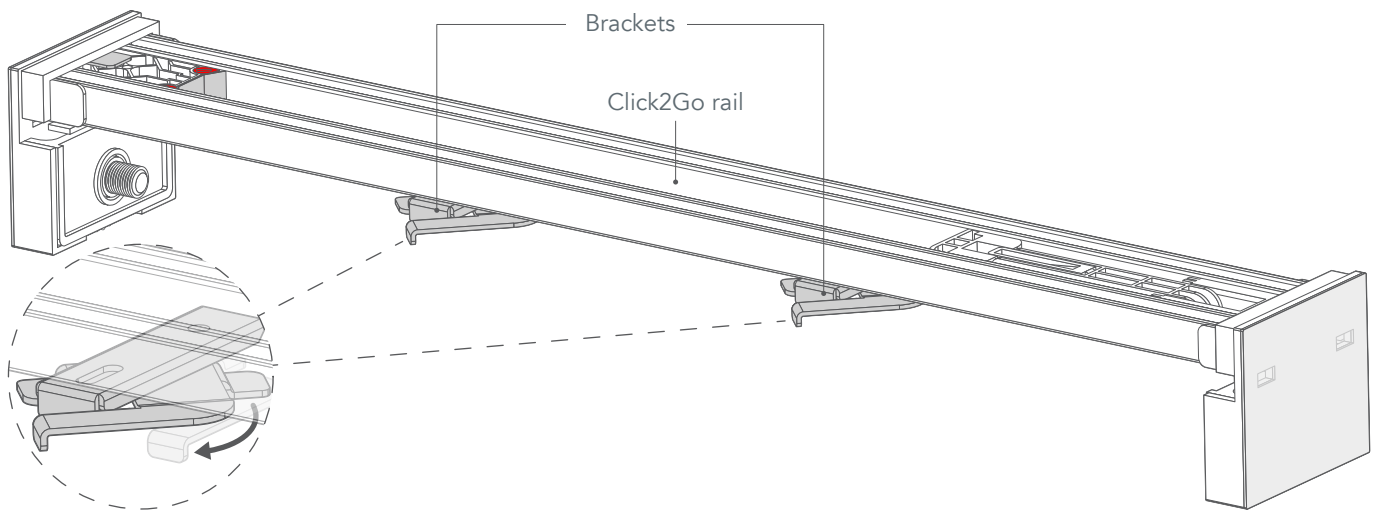

The mounting brackets are attached to the Click2Go rail already. Turn the swivel arm on each bracket so that it sits at an angle, pointing away from the rail.

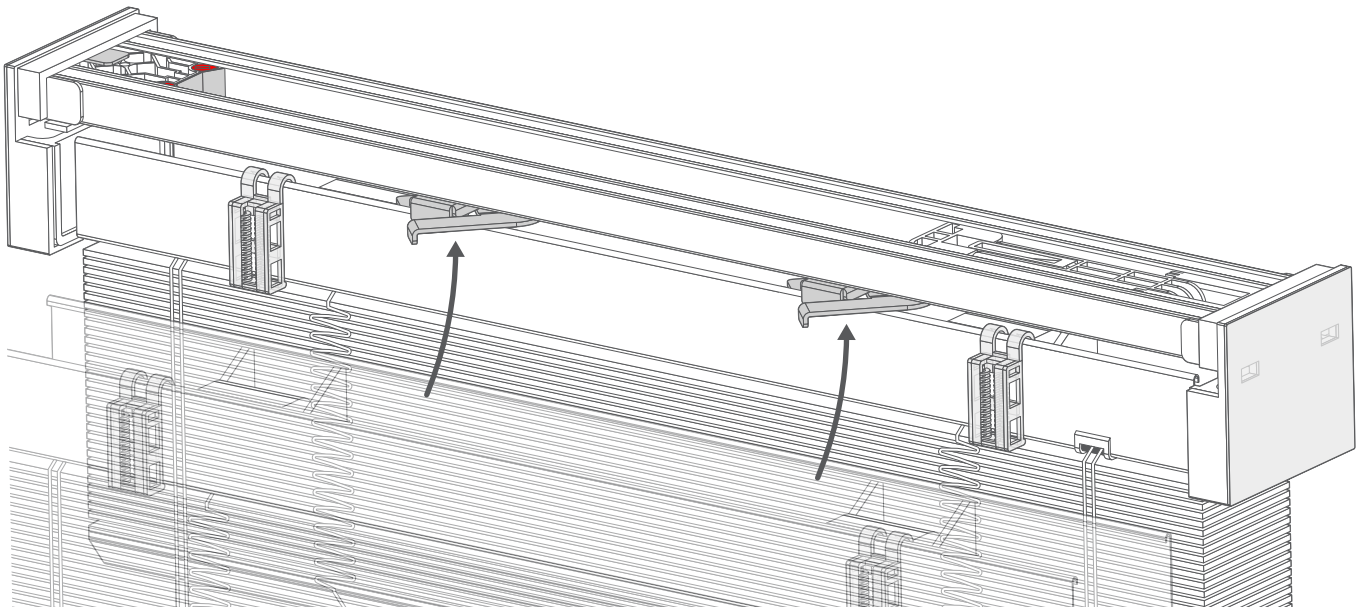

Lift the blind up to the recess and hook the headrail onto the brackets.

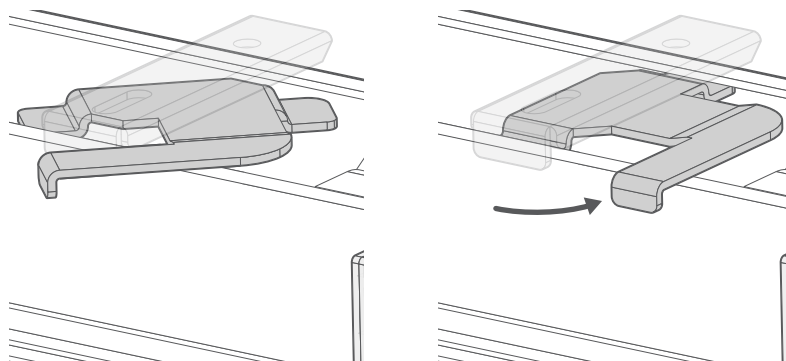

Holding the blind steady, push the swivel arm on each bracket back until it's flush with the front of the headrail, locking the blind into the brackets.

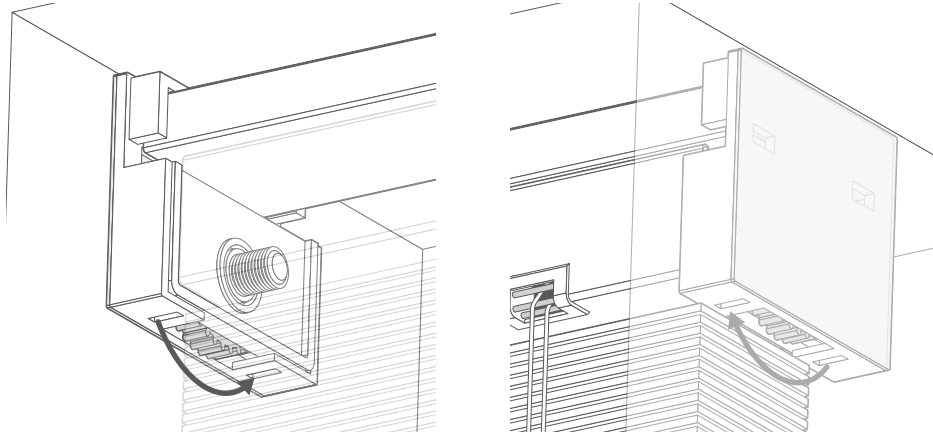

On the underside of each friction pad is a tightening wheel. Turning the wheel will push a block on the inside of each pad against the ends of the headrail, securing it fully at each end. On the left side, turn the wheel towards the window. On the right side, turn the wheel away from the window.

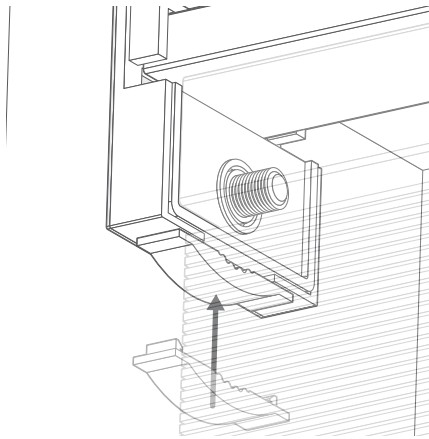

Cover plates are supplied to clip onto the bottom of each friction pad, covering the tightening wheel and preventing it from moving or slipping. Simply click the cover plate onto the bottom of the friction plate on each side.

Fitting the pelmet

3

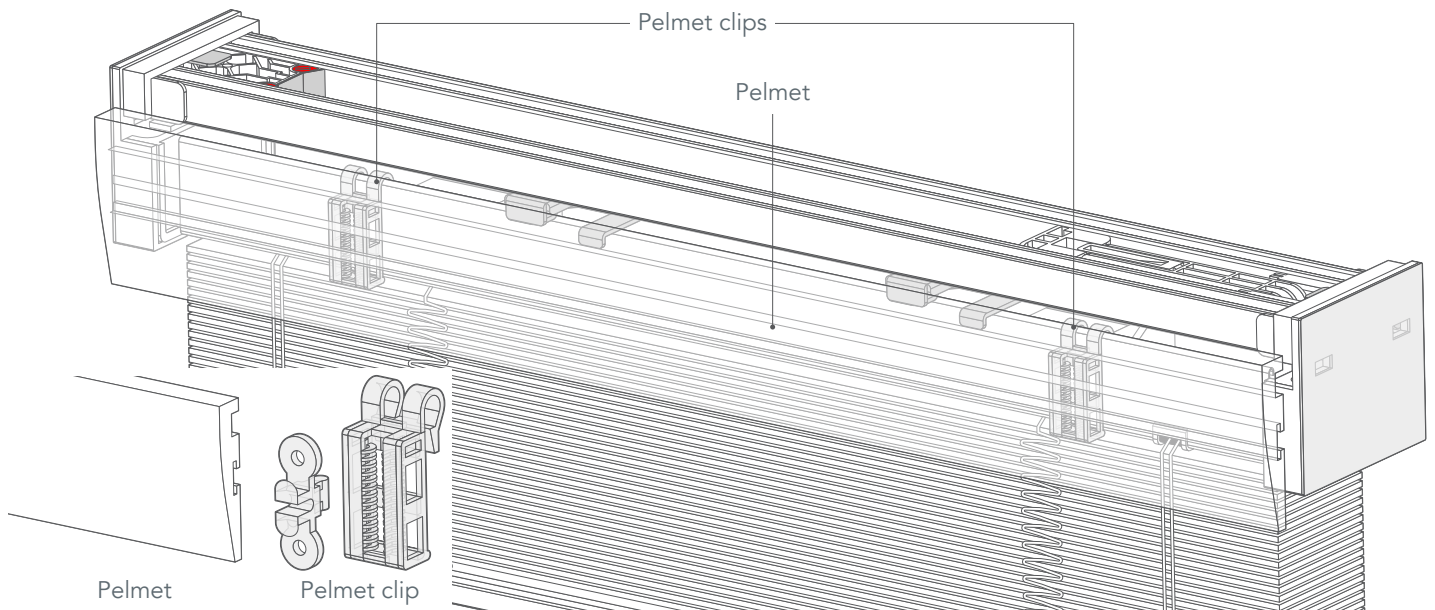

A colour-matched, decorative pelmet is supplied, which clips over the front of the headrail to cover the top of the blind and fittings.

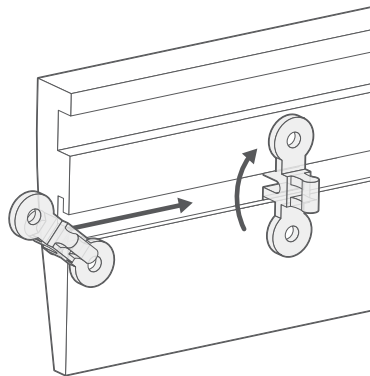

Take the smaller parts of the pelmet clips you put aside earlier; slot them into the lower channel on the back of the pelmet, spaced out across the pelmet in roughly the same positions as the other parts of the pelmet clips you hooked over the blind's headrail.

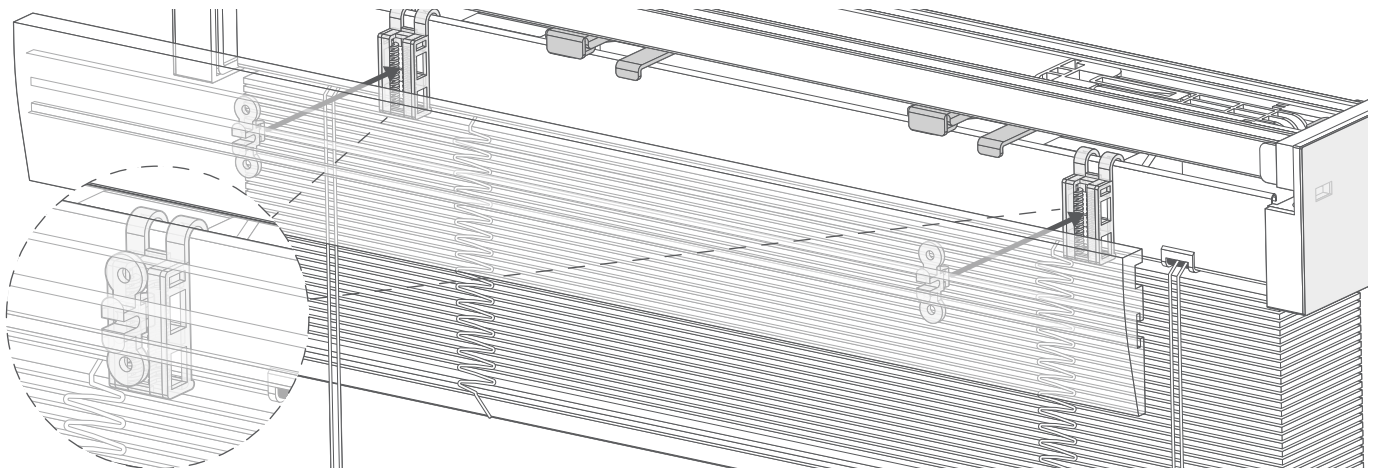

Line up the clips on the back of the pelmet, with the large clips hooked over the headrail, and push the pelmet onto the large clips to secure it. The large clips fit on the headrail loosely, so you can slide them side to side to line them up perfectly.

Child safety

4

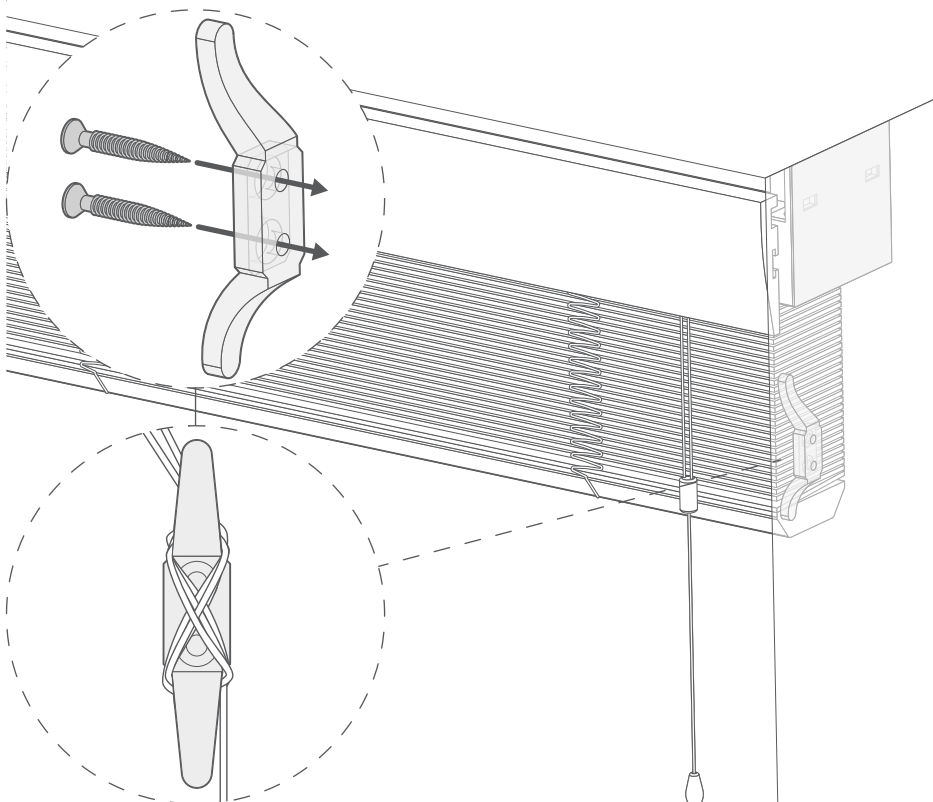

Young children can be strangled by loops in pull cords, chains, tapes and inner cords that operate the product.



To avoid strangulation and entanglement, keep cords out of the reach of young children. Cords may become wrapped around a child's neck.

Move beds, cots and furniture away from window covering cords.

Do not tie cords together. Make sure cords do not twist and create a loop.

The blind is provided with a safety cleat, to wrap the lift cord around when the blind is not in use, especially when the blind is raised.

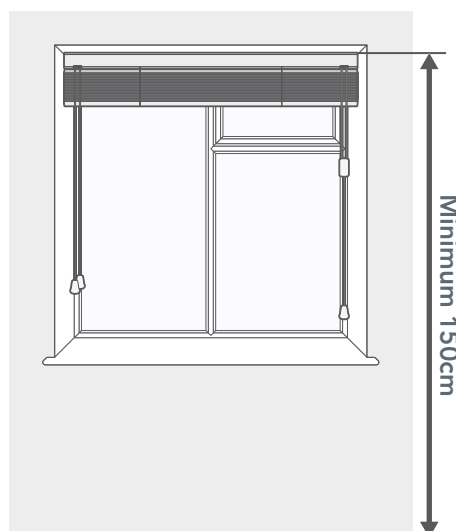

For safety reasons, always ensure that the top of the blind is installed at least 150cm (1500mm) from the floor. the safety cleat should be installed on the wall next to the blind, as close to the blind's headrail as possible.