

All of our Pleated Blinds are provided with easy to fit components to make installation a breeze. Click on the finish you've chosen for your Pleated Blind from the selection below to find a fitting guide tailored for your blind.



### Click2Go Rail

Our clever no drill fitting system, available for Standard, Cordless and SmartView Electric Pleated Blinds.

If you upgraded your blind to Click2Go, check here first.

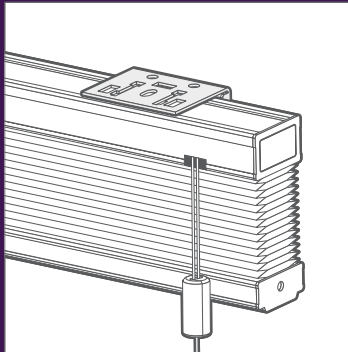

### Standard

Provided with a robust and simple pull-cord for raising and lowering, installed using standard brackets or a Click2Go rail.

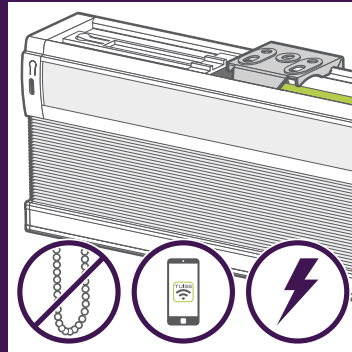

### SmartView Electric

Powered by a rechargeable motor and controlled using the free SmartView app, installed using standard brackets or a Click2Go rail.

### If you upgraded to a Click2Go™ rail

The brackets will be attached to the Click2Go™ rail for you already; you'll simply need to fit the rail into the recess, then fit the blind into the pre-attached brackets.

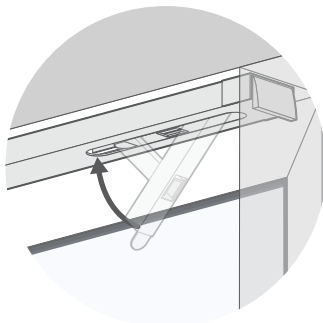

#### Top Tip

Make sure that the lever is loose and hanging down from the rail, and that the grip pad is flush with the end of the rail, before trying to place the rail into the recess. If the lever is pushed in and the pad extended, the rail will be too tight to fit in the recess.

Hold the Click2Go™ rail up against the top of the recess, then push the lever firmly upwards until the rail snaps into place. If the rail is not quite tight enough then this can be easily adjusted:

#### OPTIONAL

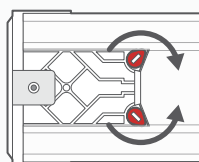

At the end of the rail opposite to the lever there is an adjustment block that allows you to fine-tune the fitting of the rail. Use a flat-head screwdriver to twist the small red plugs in toward the centre of the rail. Slide the block out of the rail by a few millimetres, then twist the red plugs back into their original position to fix the block in place. **Make small adjustments only**, repeating as necessary for a tight fit.

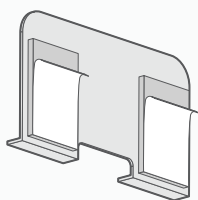

#### OPTIONAL

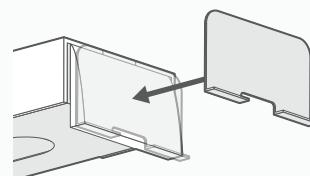

Friction plates are provided with the fittings, but these are only necessary if you find that the Click2Go™ rail slips against the wall of your recess once the blind is fitted.

To fit them, peel the covers from the sticky pads on the back, then stick one to each end of the Click2Go™ rail, as shown.

Click on one of the buttons below to continue the fitting guide. The next step will describe how to fit the blind into the brackets that are already attached to your Click2Go rail.

#### Standard

Provided with a robust and simple pull-cord for raising and lowering, installed using standard brackets or a Click2Go rail.

#### SmartView Electric

Powered by a rechargeable motor and controlled using the free SmartView app, installed using standard brackets or a Click2Go rail.

## Locating the brackets

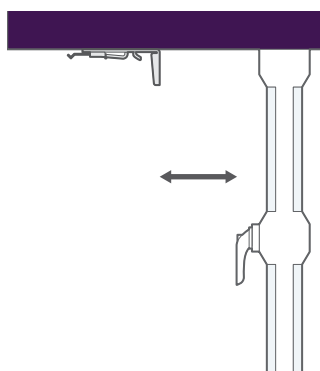

Ensure that the back of the bracket sits clear of any protruding items such as window handles or vents. This will allow the blind to hang correctly once installed.

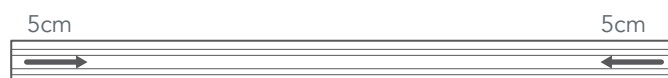

The position that you place the outermost brackets must be 5cm away from the end of the rail. Any additional brackets (supplied for wider blinds) can then be evenly distributed across the window space. Use a pencil to mark the window area where the brackets will be positioned.

## Fitting the brackets

**1**

The brackets offer two methods of installation:

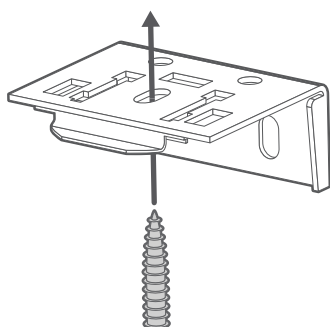

**Top-Fixing**

Use the central hole in the top of the bracket to fix to the lintel (the 'ceiling' of the recess).

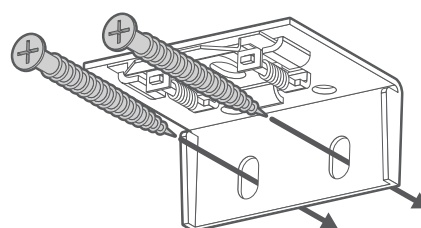

**Face-Fixing**

Use two screws through the back plate to mount onto a facing surface (a wall or window frame)

## Fitting the blind

2

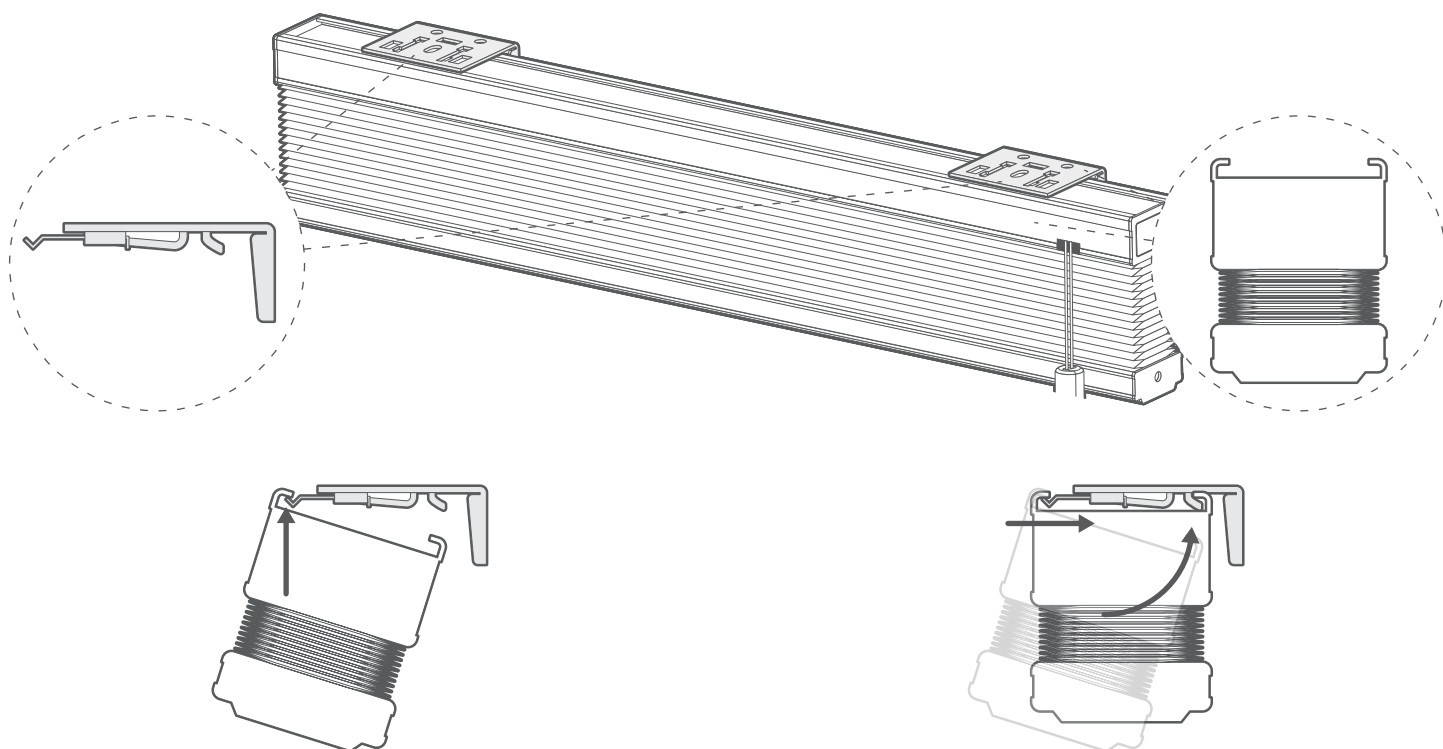

Situate the front lip of the headrail into the front of the bracket.

Push the back of the headrail upwards to lock it into the back of the bracket.

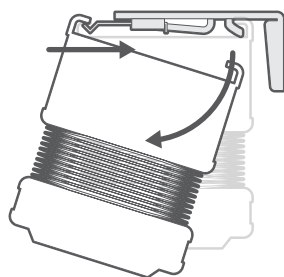

To release the blind from the brackets at any point after installing, push firmly against the blind's headrail to disengage it from the front of the bracket. At the same time, twist the back of the headrail downwards to release it from the back.

## Child Safety (Not applicable for SmartView Electric Blinds)

### Cord Condenser

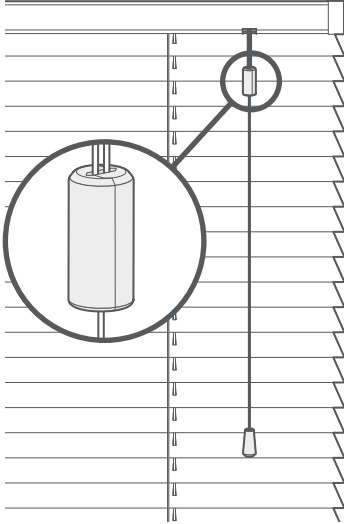

A breakaway cord condenser is pre-fitted to the lift cords so that when a horizontal force is applied to the cords above the condenser, it safely breaks away, eliminating any hazardous loops.

#### Top Tip

The design of the condenser can vary, so don't worry if yours doesn't look exactly like the illustration. Both designs do the same job and clip back together in the same way.

Top



Top

#### If the cord condenser is pulled apart:

- Untwist the cords so that they're nice and straight.
- Slot the cords into the channel in the centre of one half of the condenser. If your condenser differs slightly from the diagram, don't worry, just slot any cords that aren't already tied into place inside in the same way.
- Click the two halves back together, ensuring there is no loose thread trapped at the edges of the condenser.

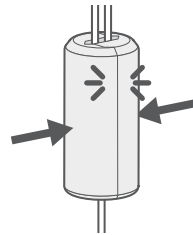
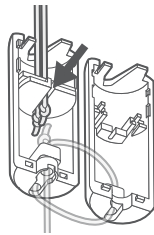

Young children can be strangled by loops in pull cords, chains, tapes and inner cords that operate the product.

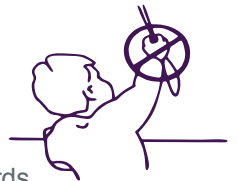

To avoid strangulation and entanglement, keep cords out of the reach of young children. Cords may become wrapped around a child's neck.

Move beds, cots and furniture away from window covering cords.

Do not tie cords together. Make sure cords do not twist and create a loop.

## Child Safety - Continued

(Not applicable for SmartView Electric Blinds)

### Cord Safety Cleat

The safety cleat shall be installed as close to the headrail as possible and in all cases not less than 1500mm from the floor. The cord must be fully accumulated around the safety cleat(s) when the blind is not in use. Use the table below to determine the distance required between the cleats to fully accumulate the cords when the blind is fully raised.

Drop of blind	*Distance between cord cleats (centre to centre)
1-1000mm	100mm
1001-2000mm	150mm
2001-3000mm	300mm

Place the safety cleat in the desired position on the wall and mark the positions of the holes with a pencil.

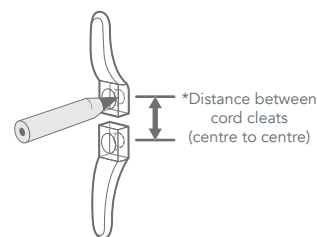

Mark the hole positions and drill as required. Use the screws provided to attach the safety cleat to the wall.

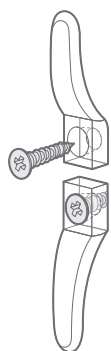

Wrap the cords around the cord cleats in a figure of 8. When the cords are fully accumulated, ensure they are secure so that when any cord is pulled, no excess cord is released.



## Locating the brackets

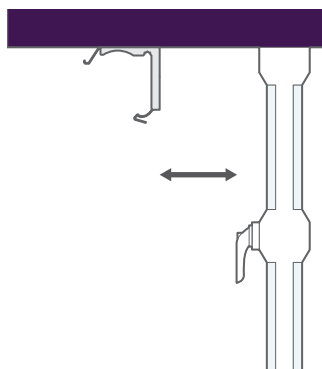

Ensure that the back of the bracket sits clear of any protruding items such as window handles or vents. This will allow the blind to hang correctly once installed.

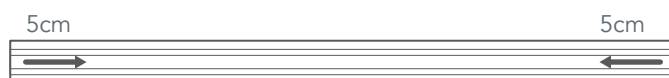

The position that you place the outermost brackets must be 5cm away from the end of the rail. Any additional brackets (supplied for wider blinds) can then be evenly distributed across the window space. Use a pencil to mark the window area where the brackets will be positioned.

## Fitting the brackets

**1**

The brackets offer two methods of installation:

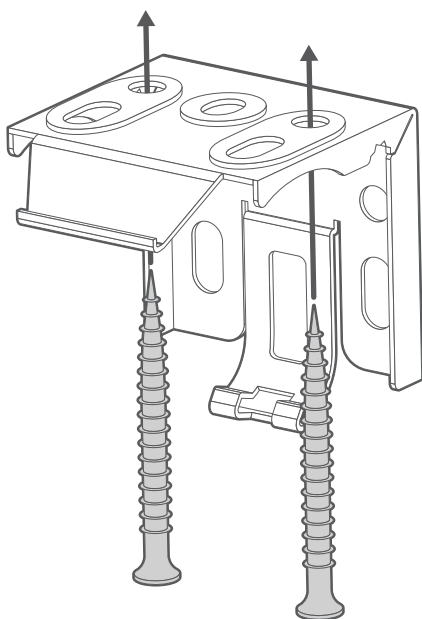

**Top-Fixing**

Use the single hole in the top of the bracket to fix to the lintel (the 'ceiling' of the recess).

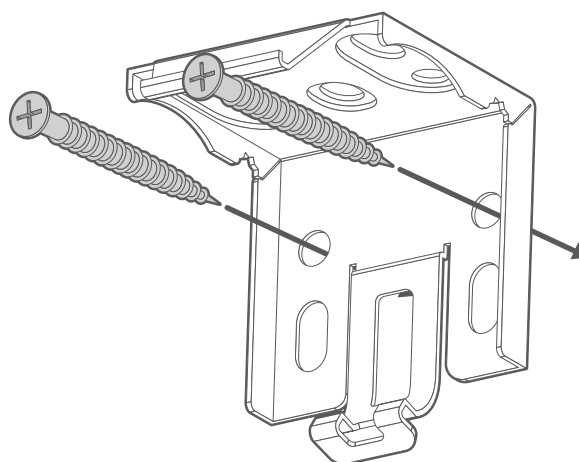

**Face-Fixing**

Use two screws through the back plate to mount onto a facing surface (a wall or window frame)

## Fitting the blind

2

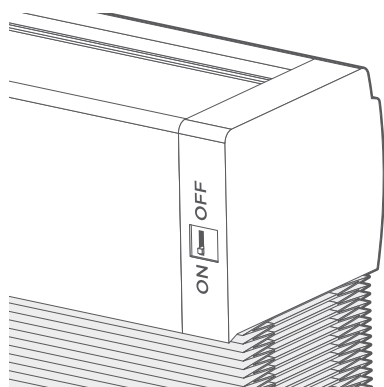
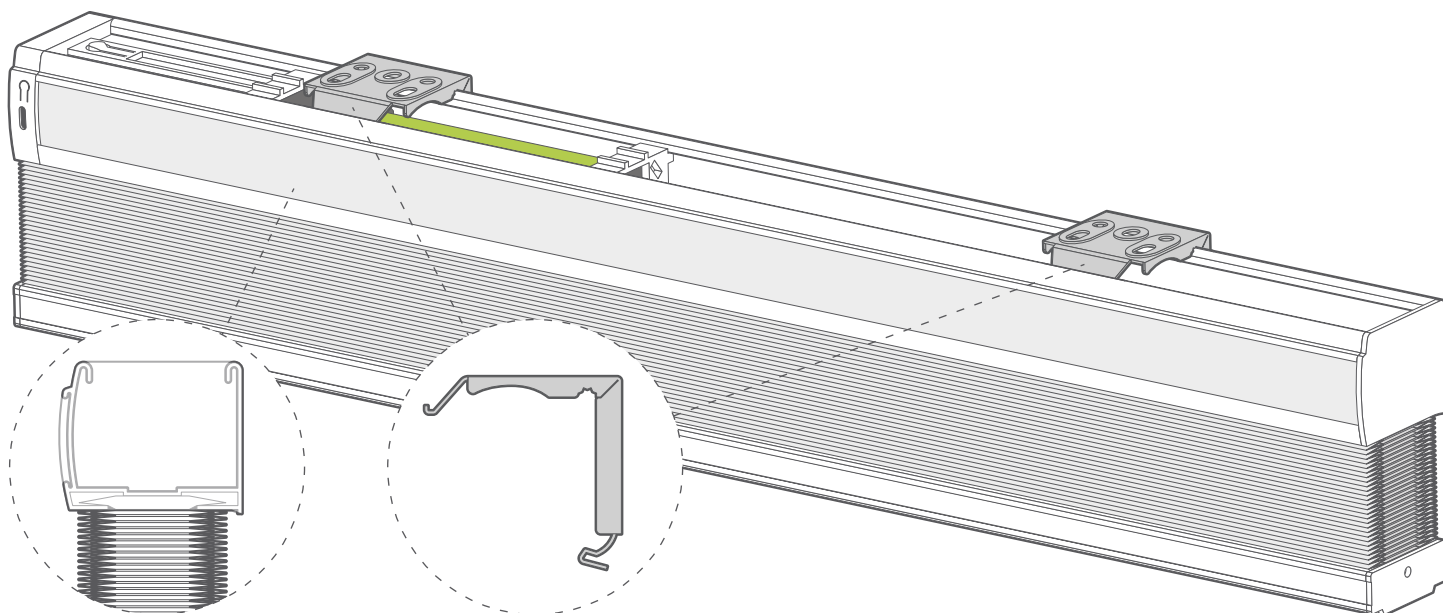

Switch the motor power switch, located on the back of the motor section, to its 'on' position.

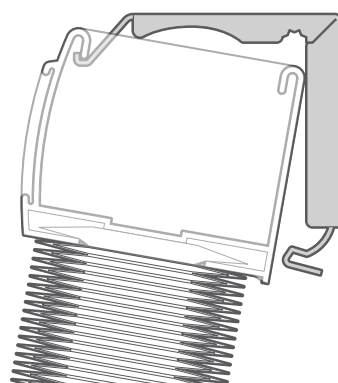

Situate the front lip of the headrail into the front hook of the bracket.

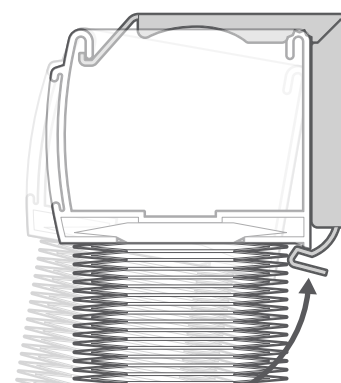

Push the back of the headrail upwards to engage the metal clip at the back of the bracket.

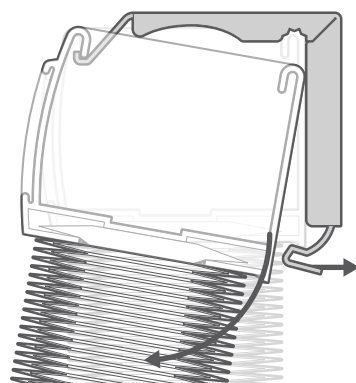

To remove the blind from the brackets, insert a flat head screwdriver into the tab protruding from the bottom of the rail, then gently pry it back while tilting the back of the rail downwards. Repeat this carefully for each bracket to release the rail.



## Additional Information

### SmartView Electric Blinds

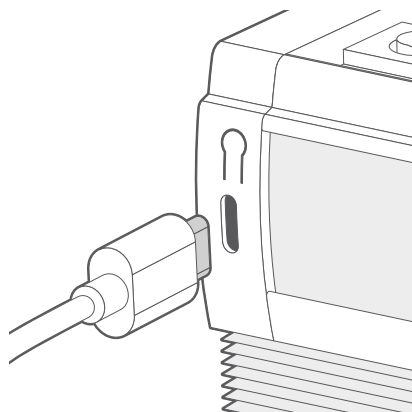

We recommend plugging in the motor to allow it to fully charge before use. Plug the charging cable (included) into the motor charging port (behind the fabric) and allow to charge until the LED on the charger plug turns green.



On the front of the swing tag that comes with your blind, you'll find a handy QR code you can scan with your phone. Scan this to download the SmartView app, and the app will guide you through the rest - you'll be setting up your blinds in moments!