

The blind, its parts, and the tools you'll need for fitting

1

Parts provided...

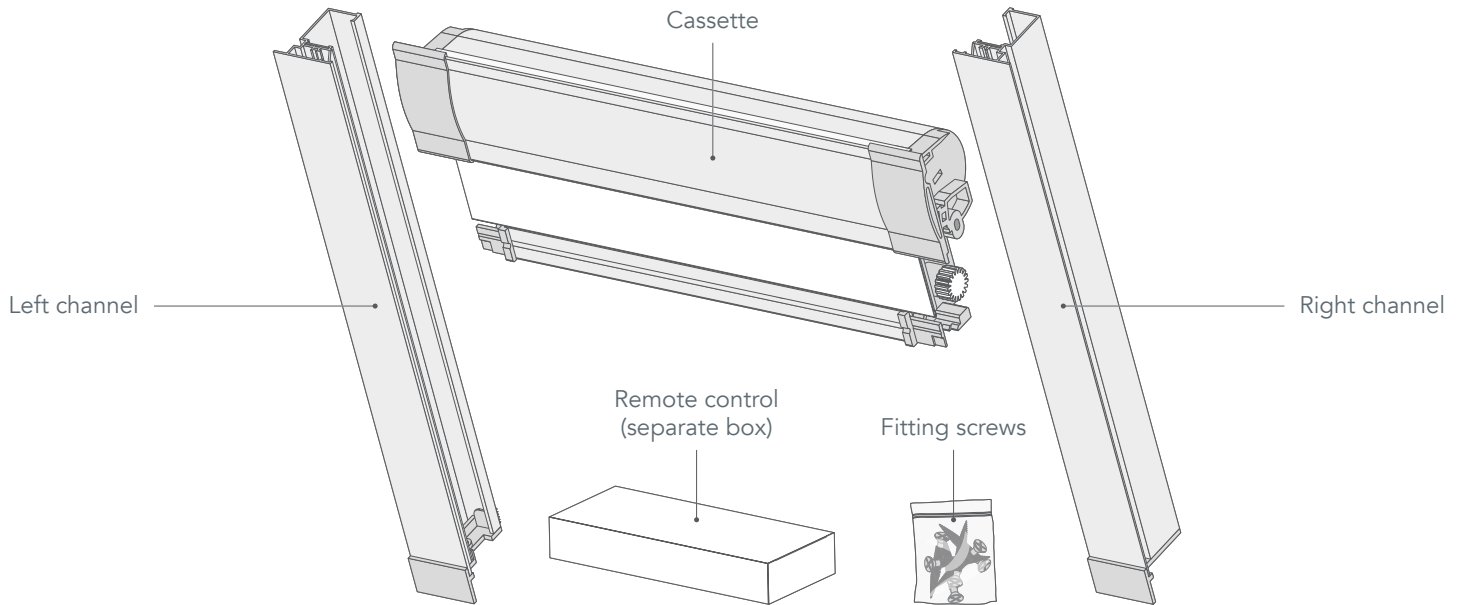

When you first unpack the blind, you'll find the cassette (which contains the fabric, and to which the motorised bottom bar is attached), the side channels, the remote control and the fitting screws all packed separately.

Tools you will need...

- 1x cross-head screwdriver
- 1x step ladder (if the window is hard to reach)

Our Skylight Blinds are 'no-drill' fitting, meaning all you'll need is a screwdriver and installation should only take a few minutes. However, if your window is high up or hard to reach, or if you just don't feel confident with DIY at all, then having someone with you to help out is always advised.

Fitting the cassette

2

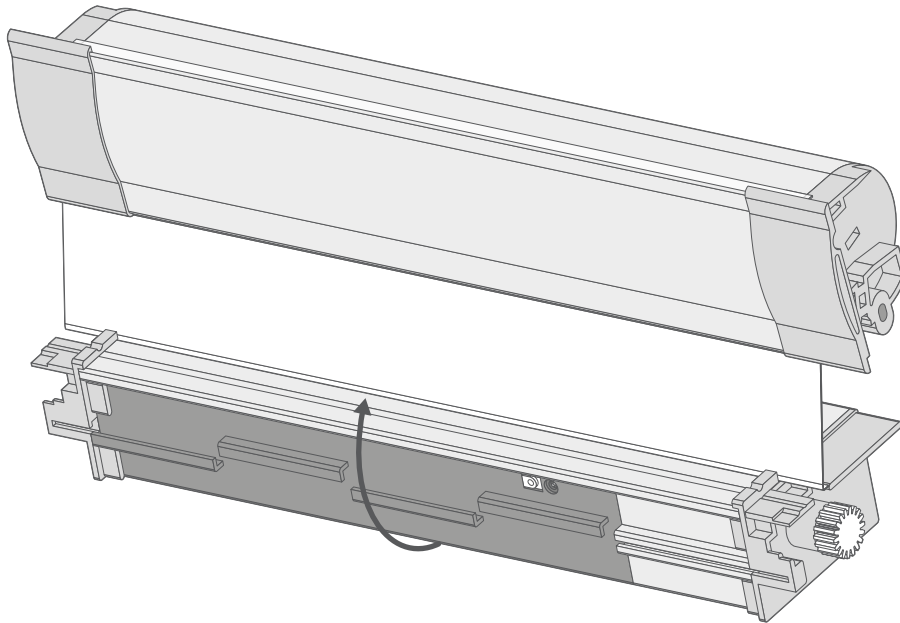

Hold the cassette, and pull the fabric and bottom bar out in front of it so that you can access the underside of the cassette.

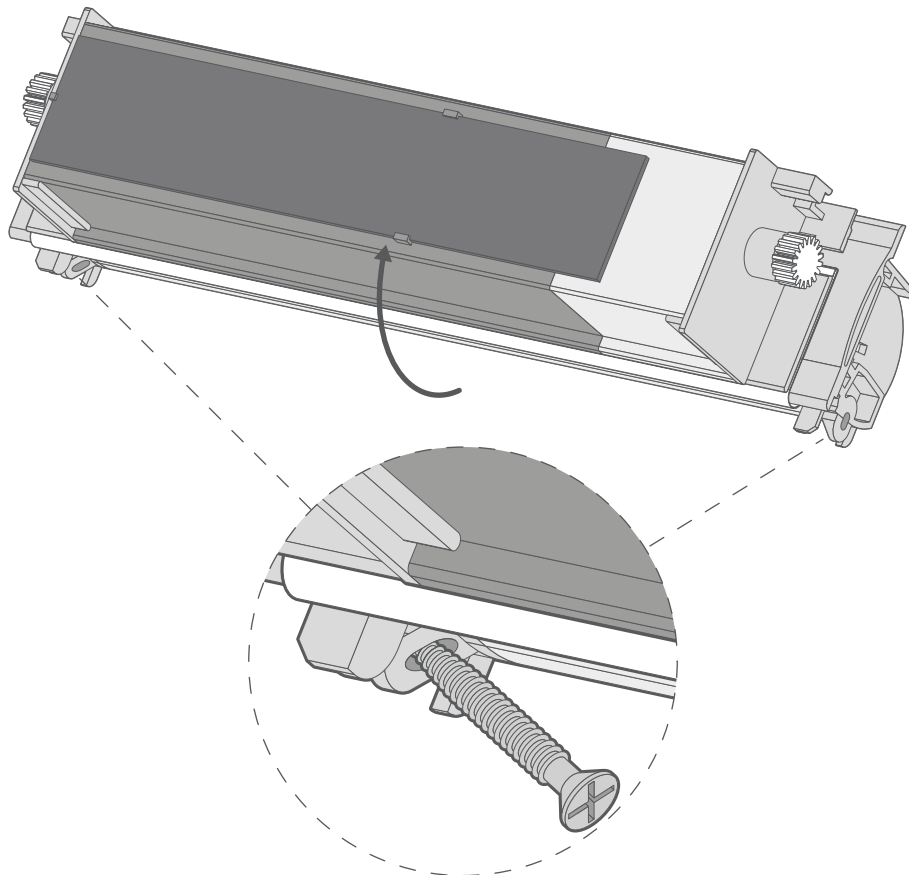

There is a small eyelet on each end of the cassette. Take two of the screws from your fittings and, just using your fingers, insert a screw into each eyelet. You only need to screw it in by half a turn or so, just enough that the screw holds, but not so much that it protrudes from the other side of the eyelet.

Fitting the cassette

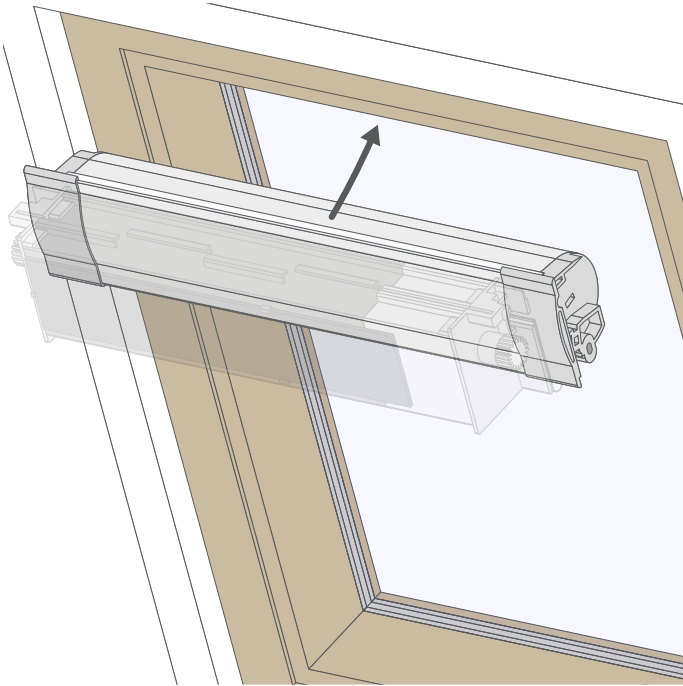

Still holding the bottom bar in front of the cassette, raise the cassette into the top of the opening window.

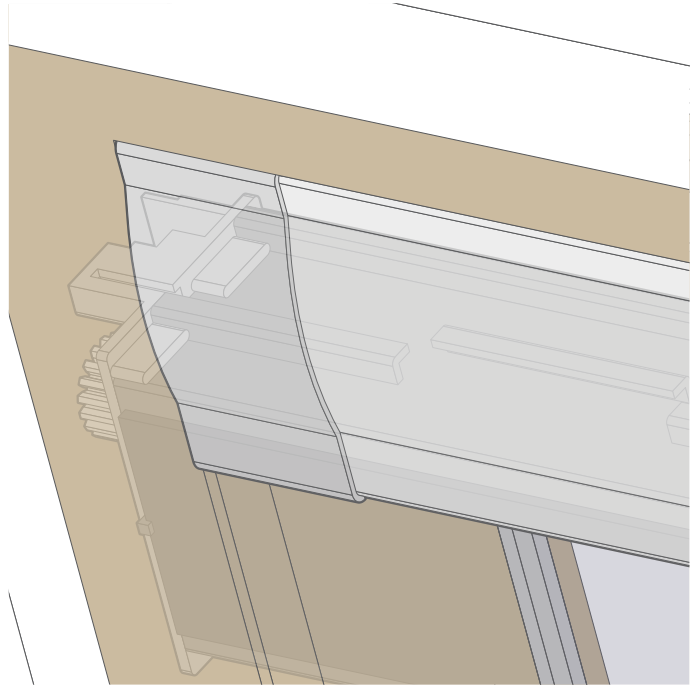

The caps on the ends of the cassette should fit neatly over the recessed corners of the opening window.

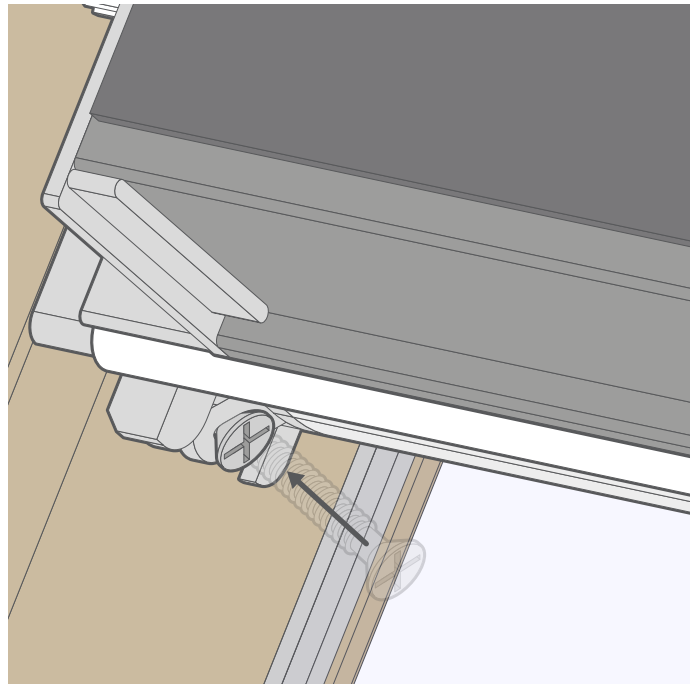
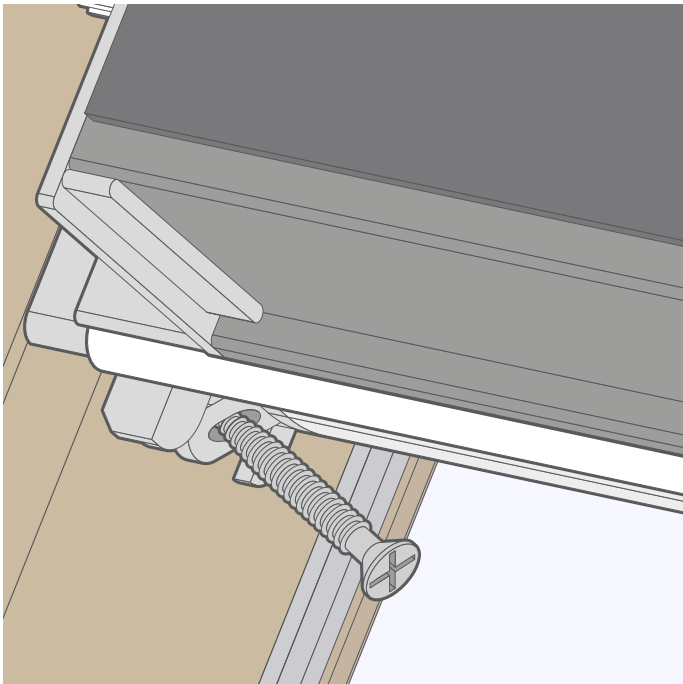

You can now use your screwdriver to fully tighten the screws you inserted in the ends of the cassette. Note that even if your window frame is white PVC, the screw can be fully inserted without drilling.

Fitting the side channels

3

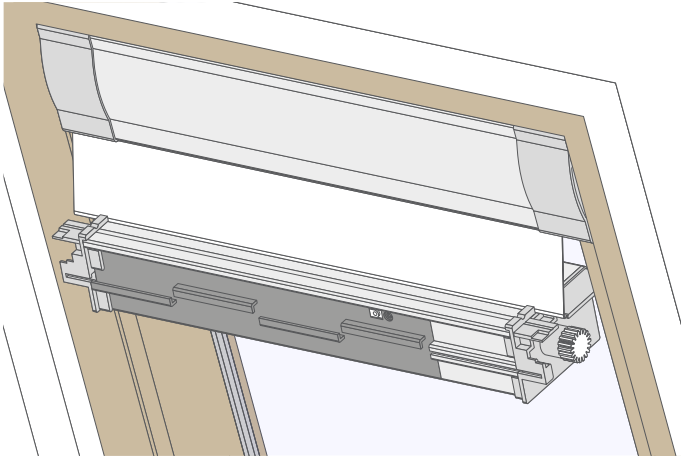

When the bottom bar is allowed to hang, the weight of the motor will 'tip' the bar backwards.

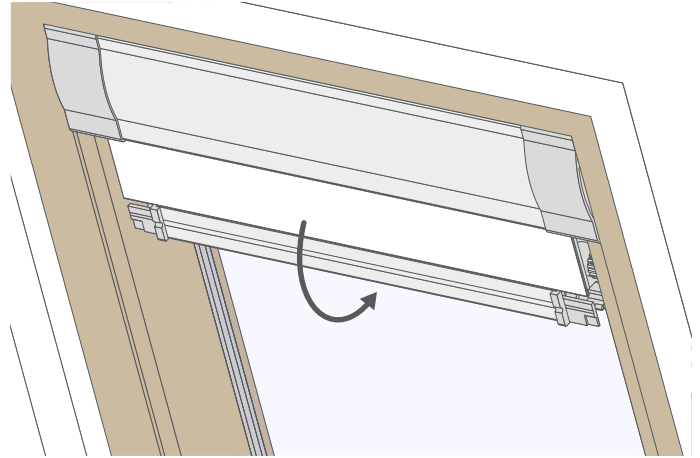

When fitting the side channels, the fabric and the front of the bottom bar should be facing toward you, with the solar panel on the back of the bottom bar facing the glass.

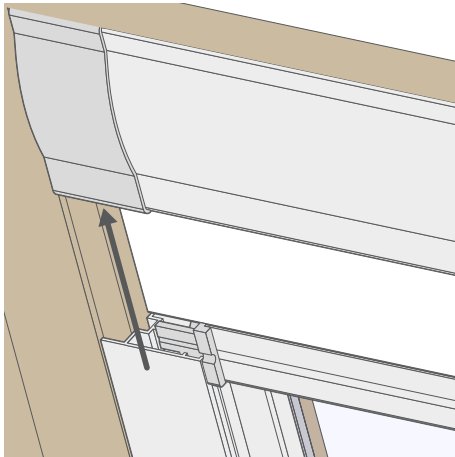

Take each channel and slide it over the tab on the ends of the bottom bar, so the edge of the fabric runs inside the channel.

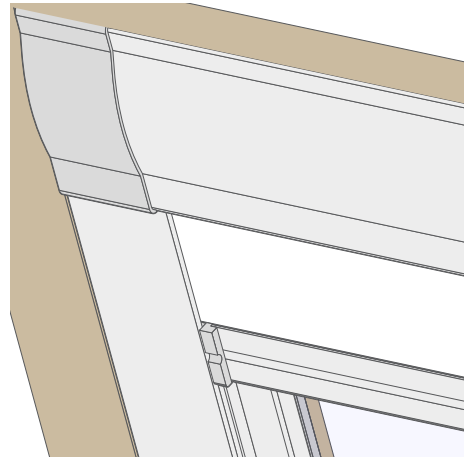

The channel should slot up against the underside of the cassette, just behind the plastic lip on the end of the cassette.

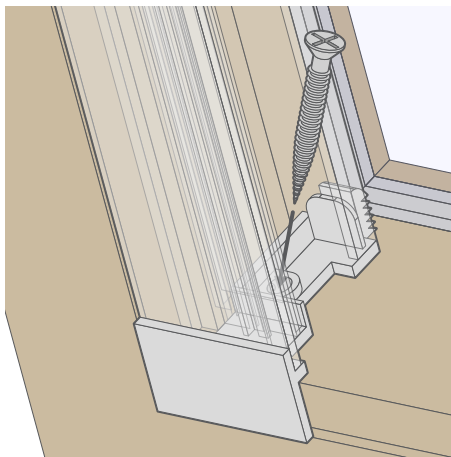

Push each channel back against the frame so that it's rigid and straight, and use one screw on each side to secure each channel in place.

Using the remote control

4

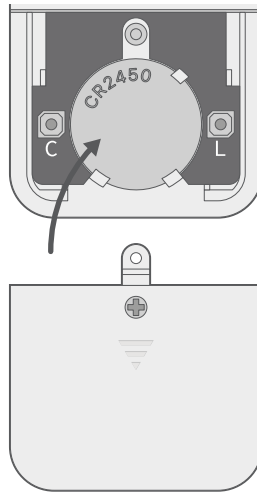

Start by inserting the remote's battery. Use the small screwdriver provided with the remote control to remove the cover on the back, then slot the CR2450 battery into its compartment, textured side-down.

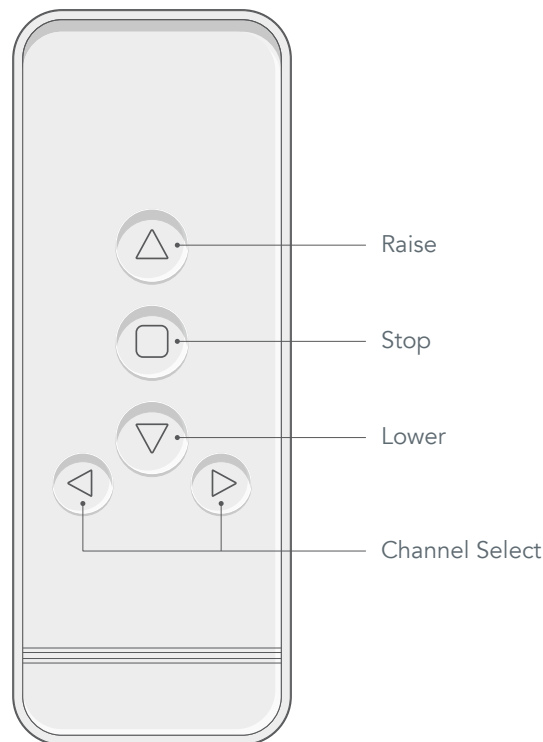

Pressing the 'Lower' button once will start the bottom bar moving downwards, if the blind is raised. It will continue to move until you press the stop button, or the blind is fully lowered.

The 'Raise' button works the same way, continuously raising the blind with a single press until it's stopped or reaches the top of the window.

Press the 'Stop' button at any time while the blind is moving to cease movement.

Separate blinds will be paired to separate channels on the remote control (maximum 5 blinds/channels). Press the 'Channel Select' buttons to toggle between different channels/blinds you'd like to control.

Pairing the remote control

5

Top-Tip

Note that the remote control will be paired to your blinds before you receive them, so for the most part you won't need to do this. This step is only relevant if any blinds have been accidentally removed from the remote control, or if you'd like to add a new blind to a remote.

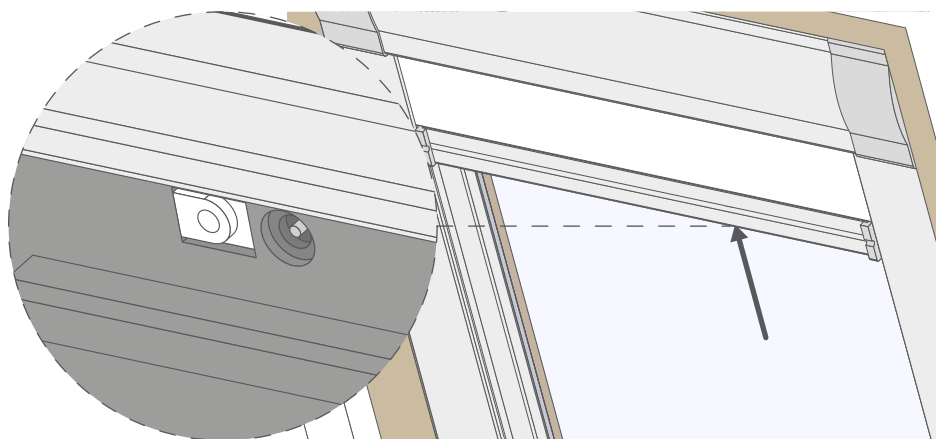

On the underside of the blind's bottom bar is a white button. This is the motor's 'setting' button. You should be able to reach this from underneath without taking the blind or the side channels out of the window. You'll need a pen or your screwdriver handy to press this button.

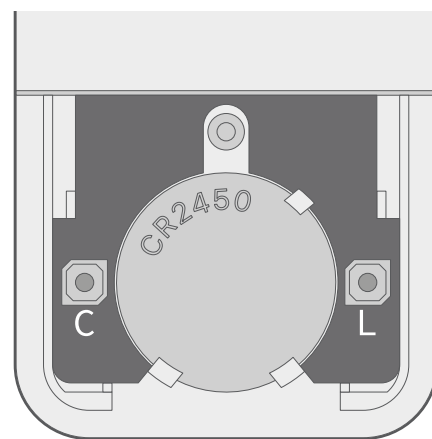

Remove the battery cover on the back of the remote to access the remote's 'setting' buttons. You'll only need the 'C' button for this process.

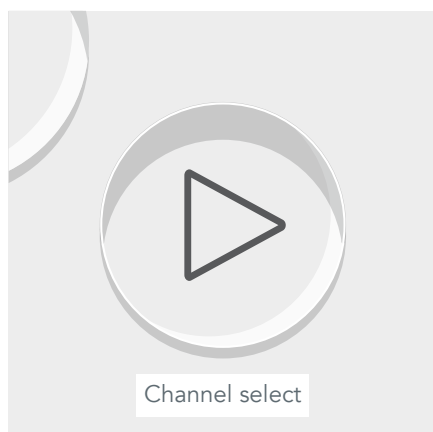

Use the 'Channel select' button the remote to choose the channel you'd like to pair the blind to. The channel is displayed on the front of the remote.

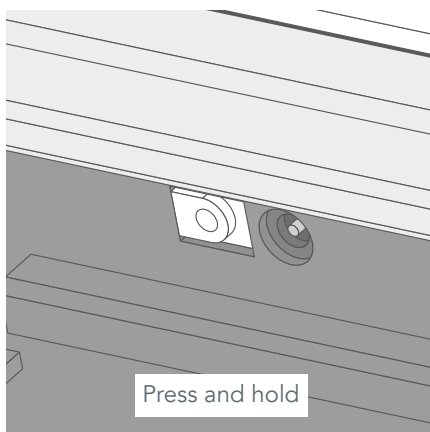

Use your pen or screwdriver to press and hold the setting button on the blind's bottom bar. Hold for a few seconds until the motor beeps.

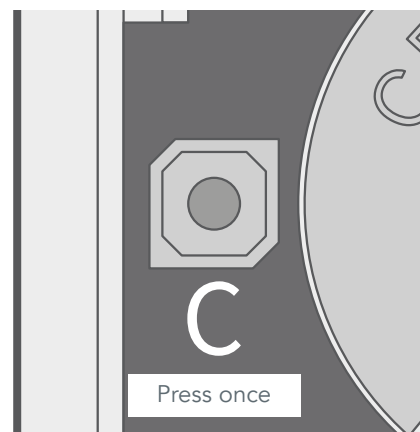

Quickly press the 'C' button on the back of the remote, whilst the motor is beeping. The motor will beep again and move up and down briefly.

And that's it! The blind is now paired to that particular channel on the remote control.